



## Plug-in Screw Connector System for Printed Circuit Boards

### TYPE 374-STG



374-STG



One assembly

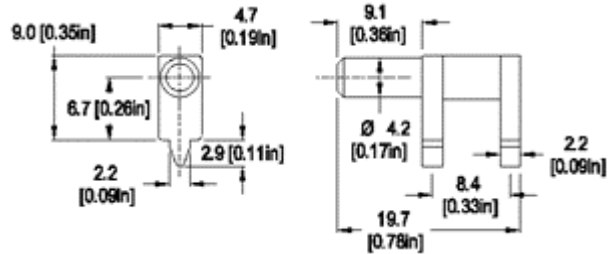

Dimensions: mm (in.)

When locating connector, allow 0.5 mm clearance around it for process-induced variations.

### Description

- Mating Post
- Plug-In Direction Parallel to PCB when plugged with 374-STFB (-DS)
- 2 PCB Pins per pole
- Straight PCB pin

### Approval Information

\* For approval information please see 374-STFB (-DS)

### Technical Data

**Recommended Hole Diameter in PC Board:**  
2.8 mm (0.11 in.)

### Material

**PCB Pin:** 4.2 mm (0.16 in.), Tin plated zinc alloy  
**PCB Pin:** 2.2 x 2.2 mm (0.09 x 0.09 in.), Tin plated zinc alloy

### Application

This product family is being used in car audio systems requiring high current flows for both power input and sound output. They can be used as power connectors in a variety of heavy-duty applications. The recommended PCB hole has been chosen for a press-fit to assure stability in the wave soldering process.

<b>Item</b>	<b>374-STG</b>
<b>Options</b>	<input type="checkbox"/> G05: Gold Plating (5 micro inches) <input type="checkbox"/> G30: Gold Plating (30 micro inches) <input type="checkbox"/> S30: Silver Plating (30 micro inches)

**Note:** Plated component: PCB mating post

### Accessories

374-STG