



Multi-Point Tab and Screw Connectors for Panel / Chassis Mounting



TYPE 3070-PCM

11 mm spacing - 1 to 21 poles



Distributor Stock Check



RoHS WEEE Pb free compliant

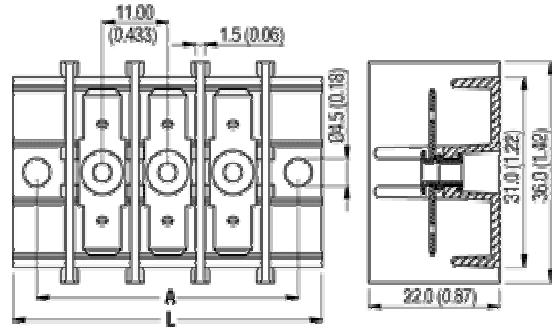

Dimensions: mm (in.)

Description

- Horizontal tab arrangements
- Recommended mounting hardware: M4 pan head screw (#8-32 pan head screw) or similar sized sheet metal screw, self-tapping screw or rivet.

Length of Connector (L)

L = No. of Poles x Center to Center Spacing + 19 mm

Distance between mounting hole centers (A)

A = No. of Poles x Center to Center Spacing + 11 mm

When locating connector, allow 0.5 mm clearance around it for process-induced variations.

Technical Data

Center to Center Spacing: 11 mm (0.433 in.)

Nominal Cross Section:

2.8 mm (0.110 in.) tabs: 1 mm<sup>2</sup> (1550 mils<sup>2</sup>) 4.8 mm

(0.187 in.) tabs: 2.5 mm<sup>2</sup> (3874 mils<sup>2</sup>) 6.3 mm

(0.250 in.) tabs: 6 mm<sup>2</sup> (9299 mils<sup>2</sup>) Screw side: 4

mm<sup>2</sup> (6199 mils<sup>2</sup>)

Wire Stripping Length: 8 mm (0.31 in.)

Approval Information

UL File No.E69841

CSA File No.LR24322

Rating	Current(A)	Voltage(V)	Application group	AWG
UL	25	300	B,C	12 max.
CSA	25	300	B,C,D,E	18-14

\* 4.8 mm tab versions are UL certified for 15 A.

Screw Tightening Torque:

UL: 10.0 lbf·in

CSA: 1.2 Nm

International Approvals:



Rated Impulse Withstand Voltage: 4000 V

Illustration

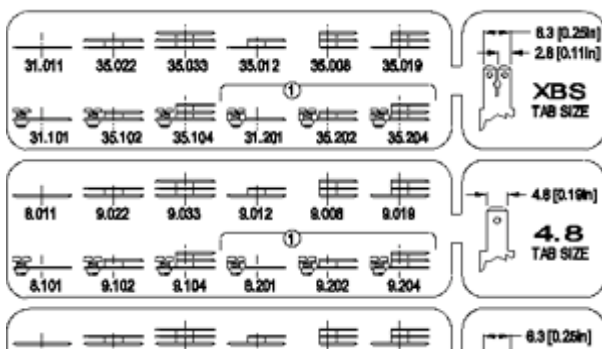

Material

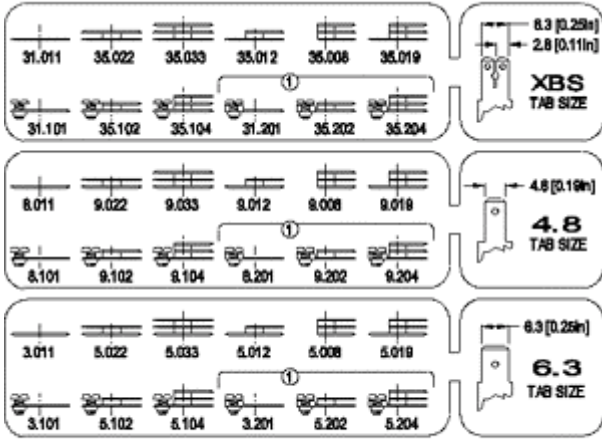

① THESE ARRANGEMENTS FEATUERE FLANGES TO PREVENT WIRES SLIPPING FROM UNDER THE SCREW HEAD

**Tab arrangement**

(1) These arrangements feature flanges to prevent wires slipping from under the screw head.

**Molding:** polycarbonate, self extinguishing to UL 94, V-0, color grey  
**Temperature limits:**  
**Short Time:** 135°C (274°F)  
**Continuous:** RTI 105°C (221°F)  
**Low Limit:** -100°C (-148°F)  
**Comparative Tracking Index:** CTI > 110  
**Oxygen Index Rating:** 40%

**Terminal Body and Tabs:** Nickel plated copper alloy  
**Screw and Pressure Plate:** Slotted head, zinc plated blue passivated, steel substrate  
**Rivet:** Tin plated copper alloy  
**Tabs:** 2.8 mm (0.110 in.), 4.8 mm (0.187 in.) or 6.3 mm (0.250 in.),  
**Screw:** M4,

**Item** 3070-PCM

**Options**

- G05: Gold Plating (5 micro inches)
- G30: Gold Plating (30 micro inches)
- S30: Silver Plating (30 micro inches)
- SM: Special Marking (please provide sketch)

**Note:** Plated component: tab and spacer

**Ordering Note:** For versions which require a mix of tab arrangements or tab sizes, please include a sketch when ordering.

**Accessories**

POLES: 01 to 21      TAB ARRANGEMENTS: (see table above)      TAB SIZE: (see table above) XBS, 4.8, 6.3

3070-PCM/  -  -