

Single Tabs for Printed Circuit Boards

GST-0-BGS | Variable Spacing - 2 poles

PICTURES



GST-0-BGS

TECHNICAL INFORMATION

Description

Technical Data

Bill of Materials

Tab: Tin plated copper alloy 4.8 x 0.8 mm (0.187 x 0.03 in.)

APPROVAL INFORMATION

Rated Current: 16A

International Approval Information

DIN VDE Related information : to DIN 46249 / 46247

TECHNICAL DRAWING

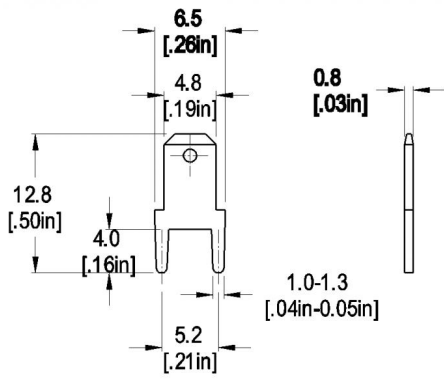

Description :
4.8 mm (0.187 in.) tab

SECTION A - SERIES GST**Terminal Blocks for Printed Circuit Boards**

These tin plated copper alloy male tabs are designed to accept female quick-connect receptacles directly to printed circuit boards. These tabs meet the requirements of the DIN 46247 standard, and are available in 3 standard tab widths: 2.8 mm (0.11 in.) - 8A, 4.8 mm (0.187 in.) -16A and 6.3 mm (0.25 in.) - 25A.

Each product has a "How To Order" area as well as a complete listing of UL and CSA approval specifications, available options and accessories.