



Plug-in Screw Connector System for Printed Circuit Boards

TYPE 971-SV (-DS)

5 mm spacing - 2 to 32 poles



Distributor Stock Check

Series	Download PDF	3D Model	Can plug with	How to order	Color specifications
--------	--------------	----------	---------------	--------------	----------------------



971-SV (-DS)



One possible variation of assembly



RoHS WEEE Pb free surface compliant

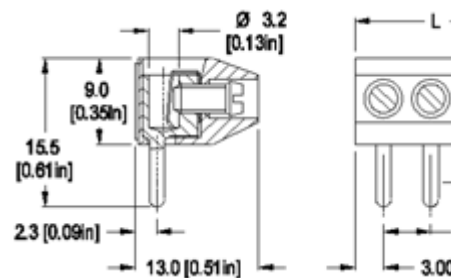

Dimensions: mm (in.)

Length of Connector (L)

L = No. of Poles x Center to Center Spacing

When locating connector, allow 0.5 mm around it for process-induced variations

Approval Information

UL File No. E69841
CSA File No. LR24322

Rating	Current(A)	Voltage(V)	Application group
UL	20	300	B,D
CSA	10	300	B,D,E

* Version DS is CSA certified for 26-14 AWG
UL: 24-26 AWG range for factory wiring

Screw Tightening Torque:

UL: 4.5 lbf-in
CSA: 0.51 Nm

International Approvals:



Rated Impulse Withstand Voltage: 25

Material

Version: 2 to 8 poles
Molding: Polyamide, self extinguishing I color grey
Temperature limits:
Short Time: 140°C (284°F)

Description

- Plug
- Plug-In Direction and Wire Entrance Perpendicular to PCB when plugged with **971-FB**
- Plug-In Direction and Wire Entrance Parallel to PCB when plugged with **970-FB**
- Plug-In Direction and Wire Entrance 45° to PCB when plugged with **974-FB**

Technical Data

Center to Center Spacing: 5 mm (0.197 in.)
Nominal Cross Section: 2.5 mm² (3874 mils²)

Wire Stripping Length: 5.5 mm (0.22 in.)

Continuous: RTI 105°C (221°F)
Low Limit: -40°C (-40°F)
Comparative Tracking Index: CTI ≥ 6
Oxygen Index Rating: 34%

Version: 9 to 32 poles
Molding: Polyamide (glass fiber reinforced) extinguishing UL 94, V-0, color grey
Temperature limits:
Short Time: 200°C (392°F)
Continuous: RTI 105°C (221°F)
Low Limit: -40°C (-40°F)
Comparative Tracking Index: CTI > 1
Oxygen Index Rating: 33%

Terminal Body: Nickel plated copper all
Wire Protector: Tin plated copper alloy
Screw: M3, Slotted head, zinc plated blue steel substrate

Top of page

How to order

Item — 971-SV (-DS)

Options

- CN: Consecutive Numbering (hot stamped numbers)
- SM: Special Marking (please provide sketch)
- PS: Zinc plated clear Passivated, steel substrate
- WG: Wire Guide
- G05: Gold Plating (5 micro inches)
- G30: Gold Plating (30 micro inches)
- S30: Silver Plating (30 micro inches)

- Request sample**
- Request quote**

Quantity

Accessories

- [BST Self Adhesive Marking](#)
- [Consecutively numbered Jumper, Type 970-J1.](#)
- [Jumper, Type 970-J2.](#)
- [Interlocking Plate, Type](#)

Note: Plated component: terminal body

971-SV

WIRE PROTECTOR:
with: - DS

POLES:
02 to 32

Add to shopping cart

2008, WECO Electrical Connectors Inc.

ISO 9001 registered quality management system