



Surface Mount Terminal Blocks

TYPE 971-SLR-SMD

5 mm spacing - 2 to 12 poles



Distributor Stock Check

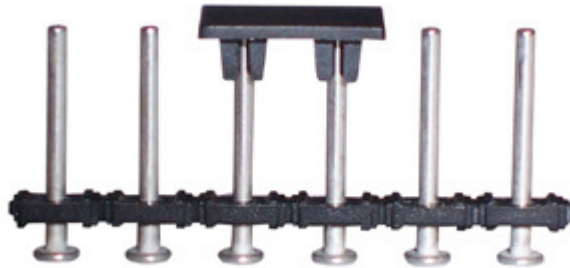

971-SLR-SMD



RoHS WEEE Pb free surface compliant

Description

US Patent # 6.224.399 B1
 Canadian Patent # 2,307,922
 Material will handle RoHS complying reflow temperatures without deforming or melting.

- Pinstrip
- Plug-In Direction Perpendicular to PCB and Wire Entrance Parallel to PCB when plugged with 950-NAF-DS, 950-NLFL-DS, 958-NLFL-DS, 950-FL-DS, 950-T-FL-DS, 950-RNF-DS, 115-F-111, 115-F-118 and 115-F-211
- Excellent coplanarity better than 0.13 mm
- Typical resistance to vertical pull off force per pin: 10 kg (depending on soldering process).
- Typical resistance to horizontal peel off force per pin: 3 kg (depending on soldering process).

Technical Data

Center to Center Spacing: 5 mm (0.197 in.)

Application

You can now convert one more component on your board to a genuine surface mount. You can increase packaging accuracy and component density, use both sides of the PCB, reduce and eliminate set-up costs and simplify and streamline your processes. The patented 971-SLR-SMD "nail head" pin design ensures a secure and reliable contact with the printed circuit board. The 0.15 mm coplanarity tolerance of this pin strip allows reliable soldering to PCB approaching zero defects for this characteristic and its effects. Plastic thermo resistant caps ensure automated pick & place-ability for both odd and even pole versions. (Consult our "Tape & Reel Data" table within our Technical Information section for details.

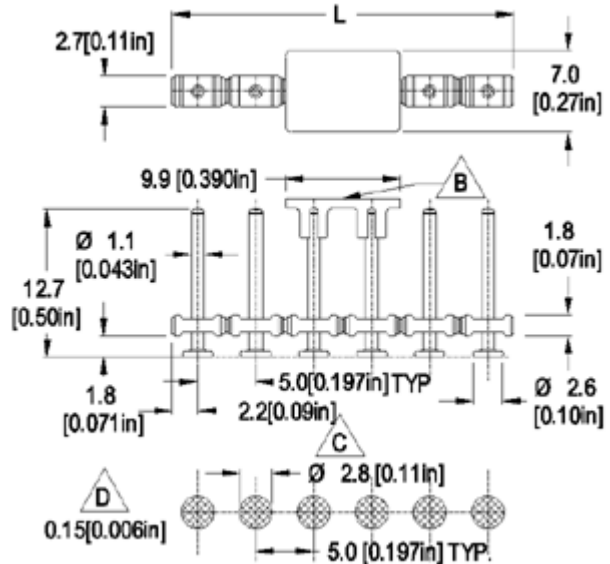

Dimensions: mm (in.)

Length of Connector (L)
 L = No. of Poles x Center to Center Spacing - 0.6 mm
 (B) Removable vacuum pick surface
 (C) Recommended pad footprint
 (D) Stencil thickness

When locating connector, allow 0.5 mm clearance around it for process-induced variations.

Approval Information

UL File No.E69841

Rating	Current(A)	Voltage(V)	Application group	AWG
UL	10	300	B	
CSA				

* CSA approvals are pending.
 Recommended current 10 A, recommended voltage 300 V

Material

Molding: HT Polyamide PA6T66, 30% GF (glass fiber reinforced), self extinguishing UL 94, V-0, color black
Temperature limits:
Short Time: 240°C (464°F)
Continuous: RTI 105°C (221°F)
Low Limit: -40°C (-40°F)
Comparative Tracking Index: CTI > 600
Oxygen Index Rating: 35%

Average weight per pole: 0.04 gram per pole,

Solder Pin: Ø 1.1 mm (0.04 in.), Tin plated copper alloy

Item

971-SLR-SMD

Options

- G05: Gold Plating (5 micro inches)
- G30: Gold Plating (30 micro inches)
- S30: Silver Plating (30 micro inches)
- TR: Tape and Reel Assembly
- PCP: Removable Pick Cap

Note: Plated component: solder pin

Accessories

POLES:
02 to 12

971-SLR-SMD/
