



PRODUCT SEARCH

TYPE NUMBER e.g.

PRODUCTS

COMPANY

CONTACT US

SUPPORT

SITE MAP

PRODUCTS



CROSS-RE

**Plug-in Screw Connector System for Printed Circuit Boards**

**TYPE 931-SLS**

3.5 mm spacing - 2 to 16 poles



Distributor Stock Check

Series	Download PDF	3D Model	Can plug with	How to order	Color specifications
--------	--------------	----------	---------------	--------------	----------------------



931-SLS



One possible variation of assembly



RoHS WEEE Pb free surface compliant

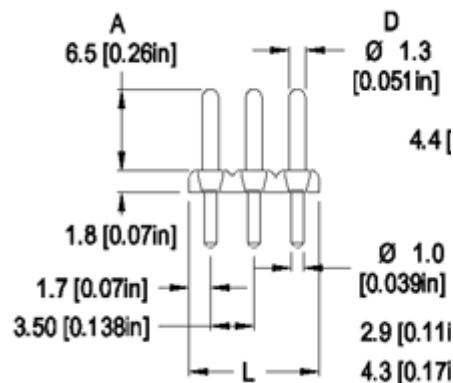

Dimensions: mm (in.)

Length of Pinstrip (L)  
 L = No. of Poles x Center to Center S  
 Other options:  
 In Ø1.10 mm diameter (D), the following pro  
 (A) are available: 7.8, 10.3, 11.0, 11.7, 11.  
 14.7 and 15.7 mm.  
 In Ø1.30 mm diameter (D), the following pro  
 (A) are available: 6.5, 7.2, 7.7, 7.8, 8.5, 10.  
 19.8, 21.5, 22.0 and 29.0 mm.

**When locating connector, allow 0.5 mm around it for process-induced vari**

**Description**

- Pinstrip
- Plug-In Direction Perpendicular to PCB and Wire Entrance Parallel to PCB when plugged with **930-FL (-DS), 938-FL (-DS)**

**Technical Data**

**Center to Center Spacing:** 3.5 mm (0.138 in.)  
**Recommended Hole Diameter in PC Board:** 1.3 mm (0.051 in.) for 1.0 mm (0.039 in.) pin (standard) 1.4 mm (0.055 in.) for 1.1 mm (0.043 in.) pin (limited options) 1.6 mm (0.063 in.) for 1.3 mm (0.051 in.) pin (limited options)

**Application**

**Approval Information**

UL File No.E69841   
 CSA File No.LR24322

Rating	Current(A)	Voltage(V)	Applicati group
UL	6	300	B
CSA	6	300	B

**Material**

**Molding:** PBT GF (glass fiber reinforced) extinguishing UL 94, V-0, color black  
**Temperature limits:**  
**Short Time:** 200°C (392°F)  
**Continuous:** RTI 105°C (221°F)  
**Low Limit:** -40°C (-40°F)

This can be plugged with the 930-FL (-DS) or 938-FL (-DS). Entry of the pin can be on top side or on the bottom of these plugs. You can stack the plug on top of each other when used with extra long pins on the 931-SLS strips. You can choose your pin length depending on the insertion forces or extraction forces required.

**Comparative Tracking Index:** CTI ≥ 60  
**Oxygen Index Rating:** 32%

**Solder Pin:** Solder side: Ø 1 mm (0.039 in.), plug-in side: Ø 1.1 mm (0.043 in.), Tin plated copper all

[Top of page](#)

## How to order

**Item** — **931-SLS**

**Options**

- G05: Gold Plating (5 micro inches)
- G30: Gold Plating (30 micro inches)
- S30: Silver Plating (30 micro inches)
- 10.5: Pin length 10.5 mm (0.413 in.)
- 16.5: Pin length 16.5 mm (0.649 in.)
- 19.8: Pin length 19.8 mm (0.779 in.)

- Request sample**
- Request quote**

Quantity

**Accessories**

**Note:** Plated component: solder pin

**Ordering Note:** To order alternate pin lengths and diameters please download the PDF file above.

POLES:  
02 to 16

**931-SLS/**

[Add to shopping cart](#)

2008, WECO Electrical Connectors Inc.

ISO 9001 registered quality management system