



Product Number: 931-SLS/05

Plug-in Screw Connector System for Printed Circuit Boards

3.5 mm spacing - 2 to 16 poles

RoHS WEEE Pb free compliant



931-SLS



One possible variation of assembly

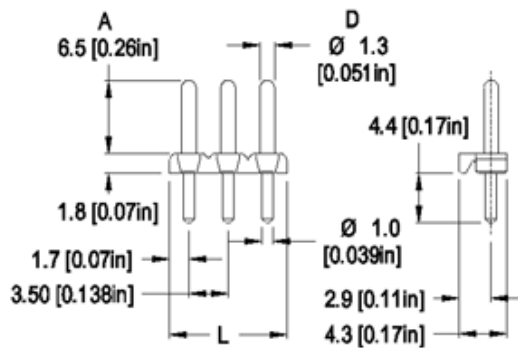

Dimensions: mm (in.)

Length of Pinstrip (L)

L = No. of Poles x Center to Center Spacing

Other options:

In \varnothing 1.10 mm diameter (D), the following protruding lengths (A) are available: 7.8, 10.3, 11.0, 11.7, 11.9, 12.5, 14.2, 14.7 and 15.7 mm.

In Ø1.30 mm diameter (D), the following protruding lengths (A) are available: 6.5, 7.2, 7.7, 7.8, 8.5, 10.5, 11.0, 16.5, 19.8, 21.5, 22.0 and 29.0 mm.

When locating connector, allow 0.5 mm clearance around it for process-induced variations.

Rating	Current(A)	Voltage(V)	Application group
UL	6	300	B
CSA	6	300	B

Description:

Tabstrip

Plug-In Direction Perpendicular to PCB and Wire Entrance Parallel to PCB when plugged with 930-FL (-DS), 938-FL (-DS)

Technical Data:

Center to Center Spacing: 3.5 mm (0.138 in.)

Recommended Hole Diameter in PC Board: 1.3 mm (0.051 in.) for 1.0 mm (0.039 in.) pin (standard) 1.4 mm (0.055 in.) for 1.1 mm (0.043 in.) pin (limited options) 1.6 mm (0.063 in.) for 1.3 mm (0.051 in.) pin (limited options)

Technical Data:

This can be plugged with the 930-FL (-DS) or 938-FL (-DS). Entry of the pin can be on top side or on the bottom of these plugs. You can stack the plug on top of each other when used with extra long pins on the 931-SLS strips. You can choose your pin length depending on the insertion forces or extraction forces required.

Material:

Molding: PBT GF (glass fiber reinforced), self extinguishing UL 94, V-0, color black

Temperature limits:

Short Time: 200°C (392°F)

Continuous: RTI 105°C (221°F)

Low Limit: -40°C (-40°F)

Comparative Tracking Index: CTI > 175
Oxygen Index Rating: 32%

Solder Pin: Solder side: Ø 1 mm (0.039 in.) or Ø1.1 (0.043 in.), plug-in side: Ø1.1 mm (0.043 in.) and Ø 1.3 mm (0.051 in.), Tin plated copper alloy

HOW TO ORDER

Item **931-SLS**

Options

- G05 Gold Plating (5 micro inches)
- G30 Gold Plating (30 micro inches)
- S30 Silver Plating (30 micro inches)
- 10.5 Pin length 10.5 mm (0.413 in.)
- 16.5 Pin length 16.5 mm (0.649 in.)
- 19.8 Pin length 19.8 mm (0.779 in.)

Note:

Plated component: solder pin