



SINGLE TABS FOR PRINTED CIRCUIT BOARDS

**GST-900-SUN**

Variable Spacing - poles

[Print this page](#)

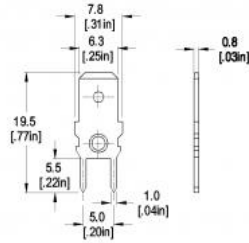

Dimensions: mm (in.)

6.3 mm (0.250 in.) tab

ZOOM

[distributor stock check](#)

[view 3d model](#)

TECHNICAL INFORMATION

APPROVAL INFORMATION

HOW TO ORDER

**Tab:** 6.3 x 0.8 mm (0.25 x 0.03 in.) Tin plated copper alloy

**Visual Description**

RoHS WEEE Pb free surface compliant





**Please fill in the How to Order box**

- |   |          |
|---|----------|
| <input type="checkbox"/> Request Sample | Quantity |
| <input type="checkbox"/> Request Quote  | Quantity |

**GST-900-SUN**

**OPTIONS:**

- G05:;ld Plating (5 micro inches)
- G30:;ld Plating (30 micro inches)
- S30: Silver Plating (30 micro inches)

**Accessories**

[ISO Insulating Sleeves.](#)

ADD TO CART