

BOARD LEVEL POWER SEMICONDUCTOR HEAT SINKS

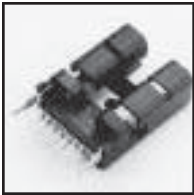

250 SERIES High-Performance SlimProfile Heat Sinks With Integral Clips

Multiwatt

| Standard P/N | Height Above PC Board in. (mm) | Footprint Dimensions in. (mm) | Mounting Configuration | Solderable Tab Options | Mounting Style | Thermal Performance at Typical Load | |
|----------------|--------------------------------|-------------------------------|------------------------|------------------------|----------------|-------------------------------------|--------------------|
| | | | | | | Natural Convection | Forced Convection |
| 250-122AB | 1.220 (31.0) | 1.000 (25.4) x .500 (12.7) | Vert./Horiz. | No Tab | Clip | 50° C @ 4W | 3.7° C/W @ 400 LFM |
| 250-122AB-09 ▲ | 1.220 (31.0) | 1.000 (25.4) x .500 (12.7) | Vertical | 09 | Clip | 50° C @ 4W | 3.7° C/W @ 400 LFM |
| 250-122AB-25 | 1.380 (35.1) | 1.000 (25.4) x .500 (12.7) | Vertical | 25 | Clip | 50° C @ 4W | 3.7° C/W @ 400 LFM |

Material: Aluminum, Black Anodized

MECHANICAL DIMENSIONS

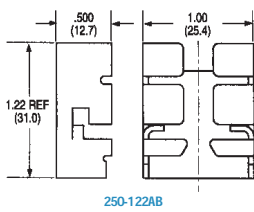

Dimensions: in. (mm)

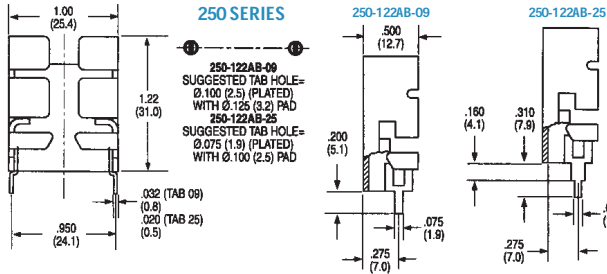

NATURAL AND FORCED CONVECTION CHARACTERISTICS

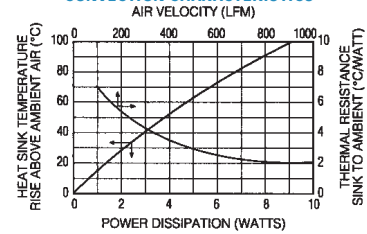

237 AND 252 SERIES High-Performance, High-Power Vertical Mount Heat Sinks

TO-220

| Standard P/N | Height Above PC Board in. (mm) | Footprint Dimensions in. (mm) | Mounting Configuration | Solderable Tab Options | Mounting Style | Thermal Performance at Typical Load | |
|---------------|--------------------------------|-------------------------------|------------------------|------------------------|----------------|-------------------------------------|--------------------|
| | | | | | | Natural Convection | Forced Convection |
| 237-167AB2 | 1.675 (42.5) | 1.000 (25.4) x 1.000 (25.4) | Vertical | 2 Twisted | Clip/Mtg Slot | 46° C @ 4W | 4.5° C/W @ 200 LFM |
| 237-167AB3 | 1.675 (42.5) | 1.000 (25.4) x 1.000 (25.4) | Vertical | 3 Twisted | Clip/Mtg Slot | 46° C @ 4W | 4.5° C/W @ 200 LFM |
| 237-167AB2-24 | 1.675 (42.5) | 1.000 (25.4) x 1.000 (25.4) | Vertical | 2 Solderable | Clip/Mtg Slot | 46° C @ 4W | 4.5° C/W @ 200 LFM |
| 252-167AB2 | 1.675 (42.5) | 1.000 (25.4) x 1.000 (25.4) | Vertical | 2 Twisted | Clip/Mtg Slot | 40° C @ 4W | 4.5° C/W @ 200 LFM |
| 252-167AB3 | 1.675 (42.5) | 1.000 (25.4) x 1.000 (25.4) | Vertical | 3 Twisted | Clip/Mtg Slot | 40° C @ 4W | 4.5° C/W @ 200 LFM |
| 252-167AB2-24 | 1.675 (42.5) | 1.000 (25.4) x 1.000 (25.4) | Vertical | 2 Solderable | Clip/Mtg Slot | 40° C @ 4W | 4.5° C/W @ 200 LFM |

Order SpeedClips™ 285SC or 330SC separately for rapid component installation, lowering manufacturing costs. Material: Aluminum, Black Anodized

MECHANICAL DIMENSIONS

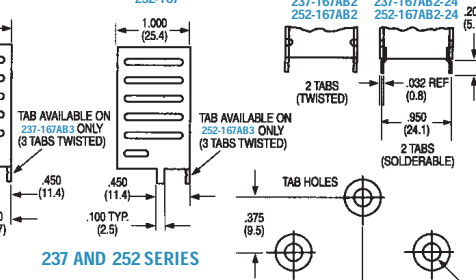
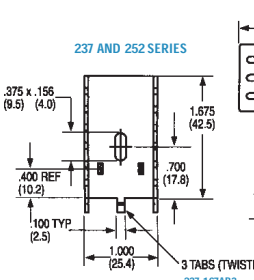

NATURAL AND FORCED CONVECTION CHARACTERISTICS

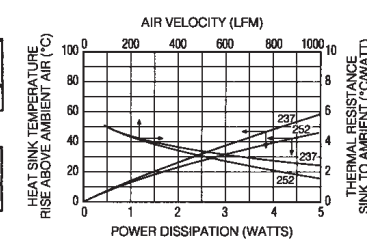

291 SERIES Labor-Saving Clip-on Heat Sinks

TO-220

| Standard P/N | Height Above PC Board in. (mm) | Vertical Mounting Footprint Dimensions in. (mm) | Mounting Style | Thermal Performance at Typical Load | | Weight lbs. (grams) |
|--------------|--------------------------------|---|--------------------|-------------------------------------|-------------------|---------------------|
| | | | | Natural Convection | Forced Convection | |
| 291-C236AB | 0.860 (21.9) | 1.100 (27.0) x 0.360 (9.1) | TO-220 (Clip) | 80° C @ 2W | 24° C/W @ 600 LFM | 0.0026 (1.18) |
| 291-H36AB ▲ | 0.860 (21.9) | 1.100 (27.0) x 0.360 (9.1) | TO-220 (Mtg. Hole) | 68° C @ 2W | 16° C/W @ 600 LFM | 0.0026 (1.18) |

Material: Aluminum, Black Anodized

Designed for mounting horizontally or vertically on a circuit board, 291 Series heat sinks employ a unique clip for attachment of TO-220 case styles.

One type is available with a locking clip and one with a 0.140 in. (3.6) diameter mounting hole only.

MECHANICAL DIMENSIONS

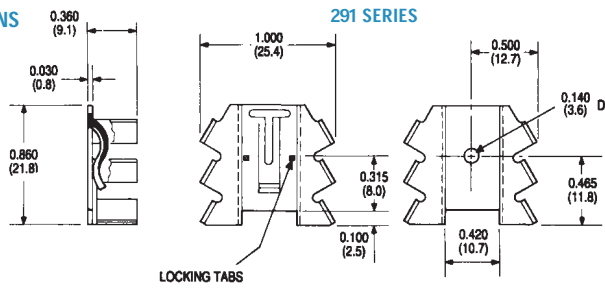

Dimensions: in. (mm)

NATURAL AND FORCED CONVECTION CHARACTERISTICS

