

Snap-on Cores for Round Cables

[RoHS Compliant]



●ESD-SR Series

Model	Dimensions (mm)			φD	Weight (g)	Color of case
	A max.	B max.	C max.			
ESD-SR-100	16.5	16.5	21.0	Up to 6.0	7.2	Black, Gray, Violet
ESD-SR-110	14.4	14.2	28.0	Up to 5.0	6.9	Black, Gray, Violet
ESD-SR-S10	15.5	14.0	18.5	Up to 6.0	4.1	Black
ESD-SR-120	16.0	16.4	33.0	Up to 6.0	13.3	Black, Gray, Violet
ESD-SR-150	19.6	20.3	37.4	Up to 7.0	23.4	Black, Gray, Violet
ESD-SR-160	20.2	20.0	39.0	Up to 9.0	22.7	Black, Gray, Violet
ESD-SR-250	31.5	31.6	38.0	Up to 13.0	59.5	Black, Gray, Violet
ESD-SR-S16	23.0	20.0	20.5	Up to 8.0	12.9	Black
ESD-SR-S25	33.0	29.0	15.5	Up to 14.5	21.3	Black

●The Violet case is built-to-order item.

ESD-SR Series

- Temperature Index : 65°C
- Flame Class : UL94V-0
- CTI : Rank 0

Shape and Dimensions

●ESD-SR-□□□□

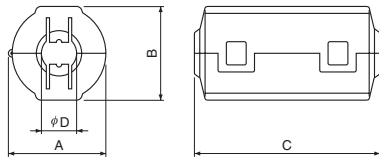

●ESD-SR-S□□□

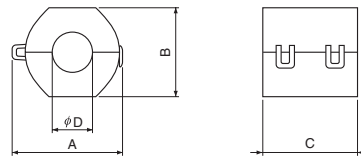

Case Color

- ESD-SR-□□□□□ (blank) Black
- ESD-SR-□□□□G Gray
- ESD-SR-□□□□V Violet
- *Black only for ESD-SR-S□□□

Impedance vs. Frequency

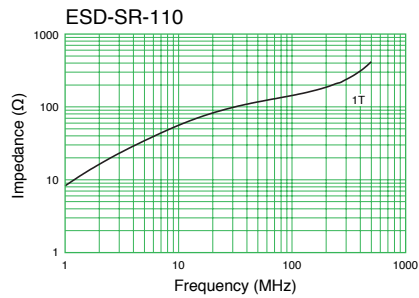
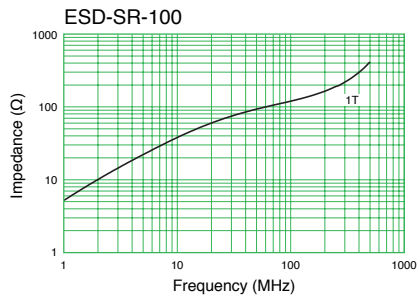

EMI Core VOL.06



- All specifications in this catalog and production status of products are subject to change without notice. Prior to the purchase, please contact NEC TOKIN for updated product data.
- Please request for a specification sheet for detailed product data prior to the purchase.
- Before using the product in this catalog, please read "Precautions" and other safety precautions listed in the printed version catalog.

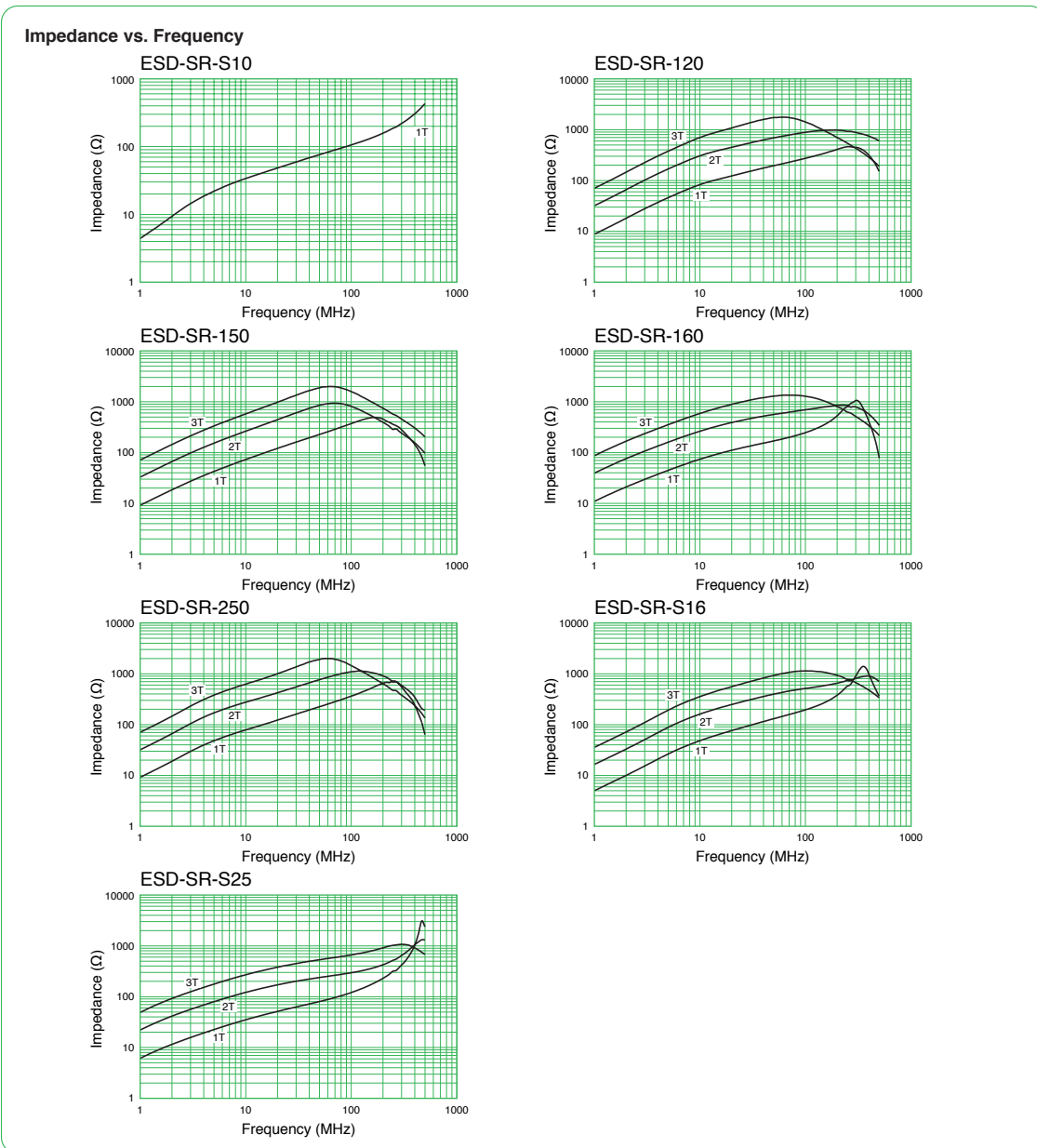

- All specifications in this catalog and production status of products are subject to change without notice. Prior to the purchase, please contact NEC TOKIN for updated product data.
- Please request for a specification sheet for detailed product data prior to the purchase.
- Before using the product in this catalog, please read "Precautions" and other safety precautions listed in the printed version catalog.