

THIS DRAWING IS UNPUBLISHED. RELEASED FOR PUBLICATION  
 © COPYRIGHT BY TYCO ELECTRONICS CORPORATION. ALL INTERNATIONAL RIGHTS RESERVED.

LOC		DIST		REVISIONS				
P	LTR	DESCRIPTION			DATE	DWN	APVD	
		D		REVISED PER ECO-09-028142	11MAR2010	DD	WW	

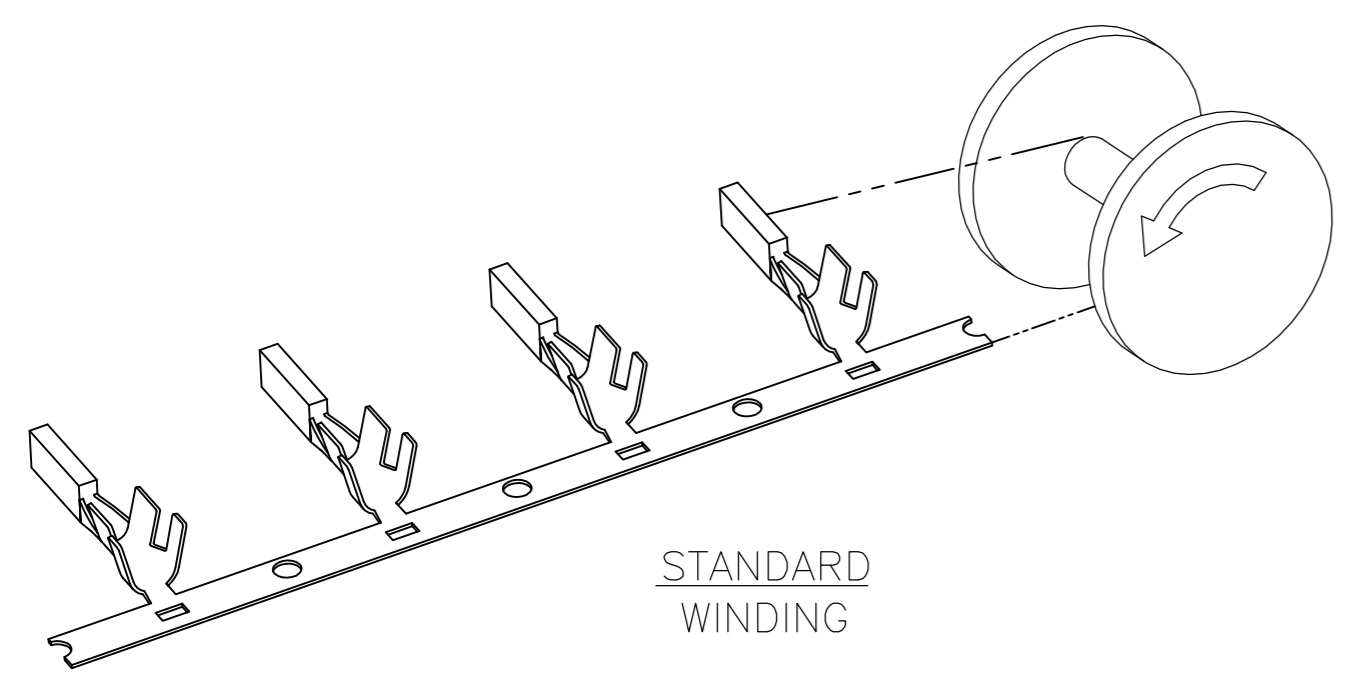
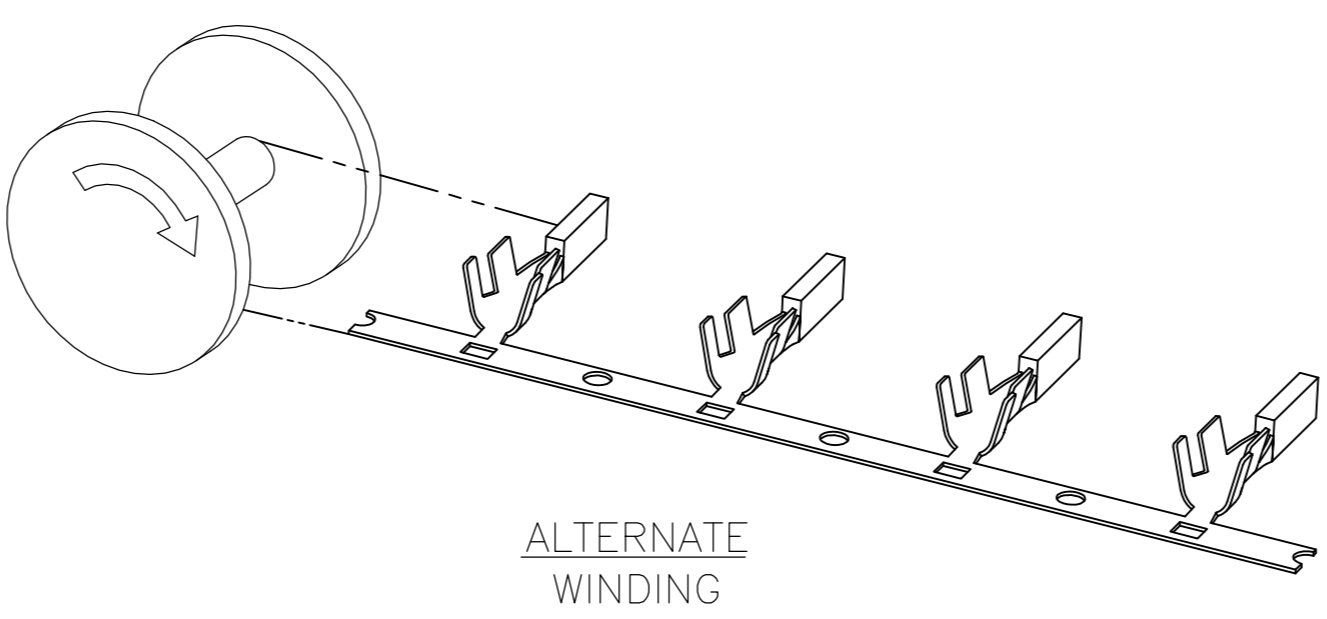
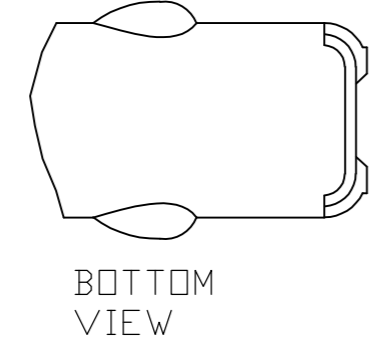
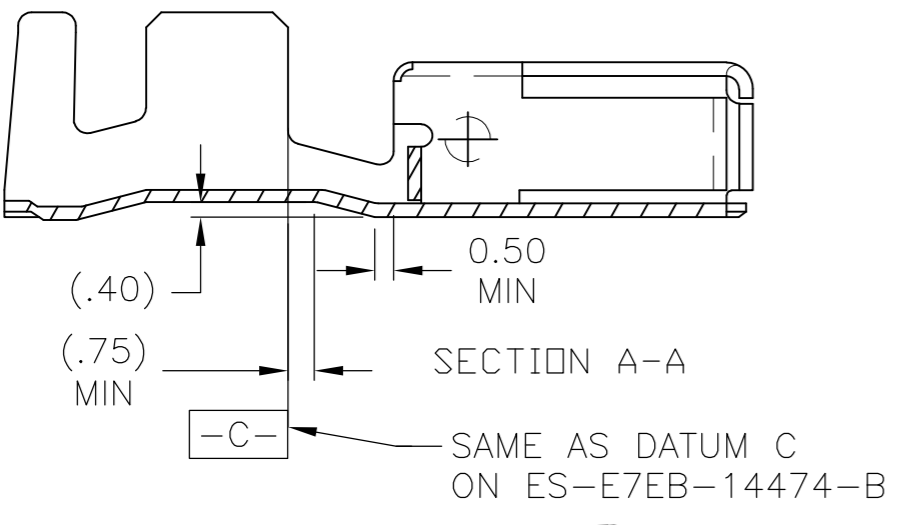
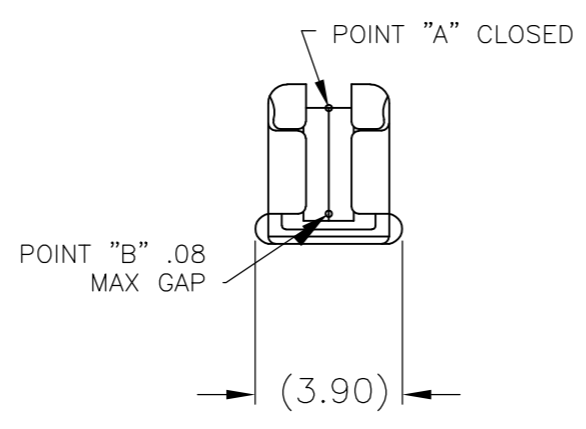
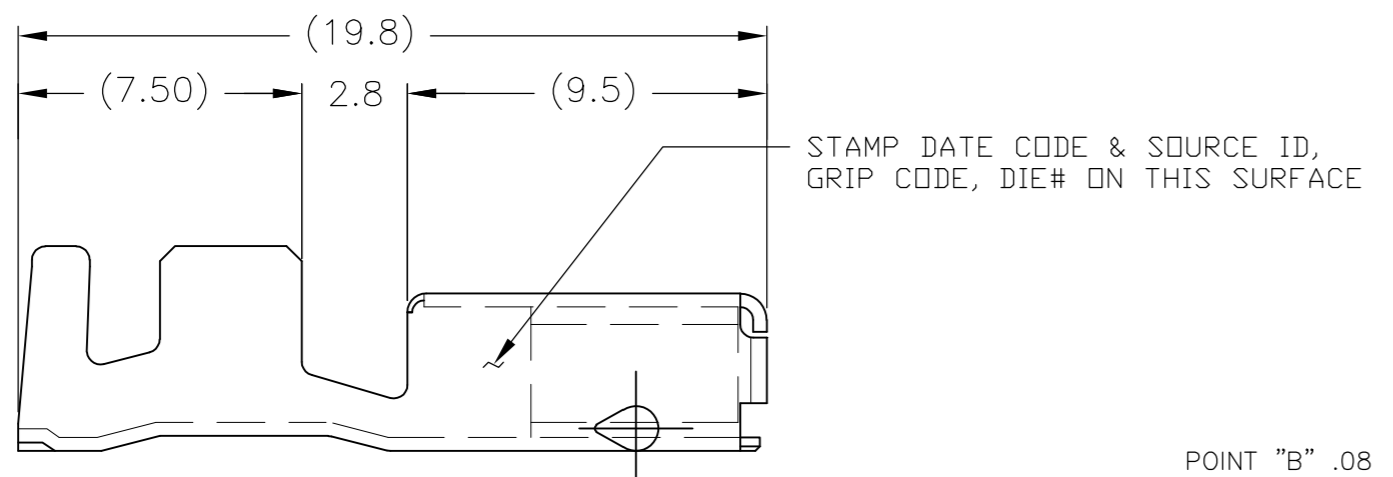
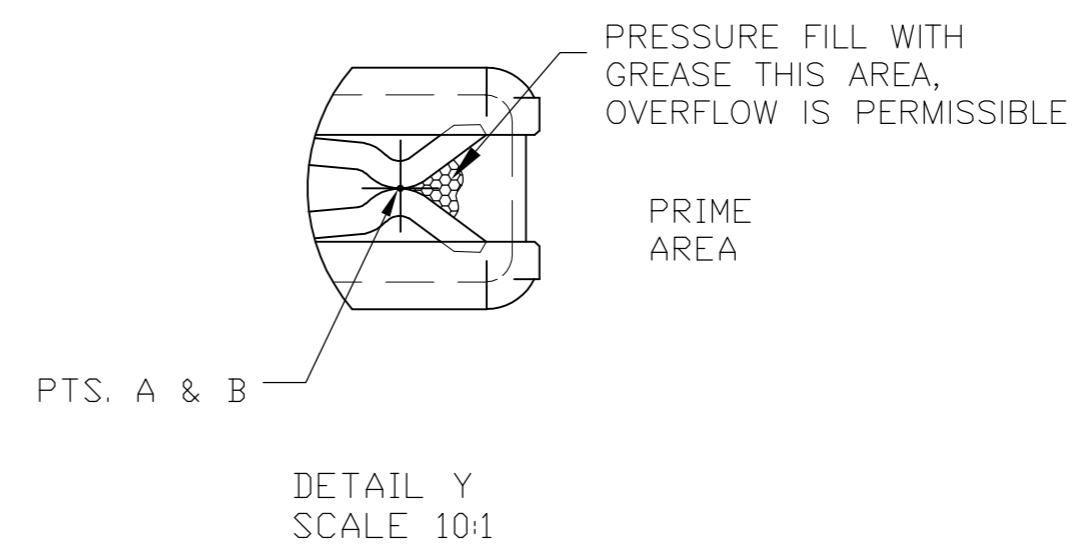
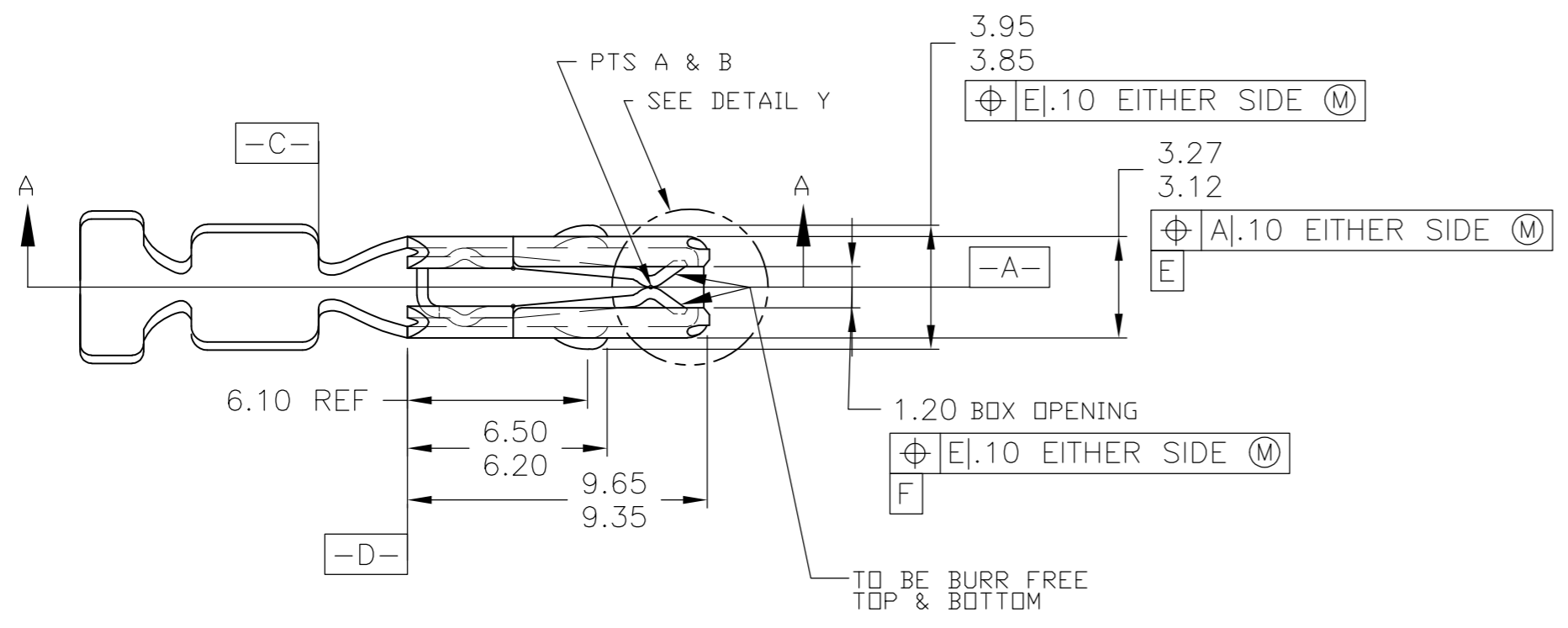

NOTES: UNLESS OTHERWISE SPECIFIED

- GENERAL TOLERANCES:  
 ± .3 ALL ONE PLACE DIMENSIONS  
 ± .15 ALL TWO PLACE DIMENSIONS  
 ± 1.00° ALL ANGULAR DIMENSIONS
- \* CRIMPING OF TERMINALS TO WIRE MUST MEET ALL REQUIREMENTS OF ES-E7E8-14474-A
- FOR WIRE INSULATION DEFORMATION SPECIFICATIONS SEE ES-E4EB-14461-AA
- MATERIAL: UNS C19500 BRASS, 1/2 HARD (REF)  
 FINISH: WSB-NIP9-B TIN PLATE - HOT DIP, PRE-TIN STRIP EXCEPT PLATING THICKNESS TO BE A MINIMUM OF 035u INCH

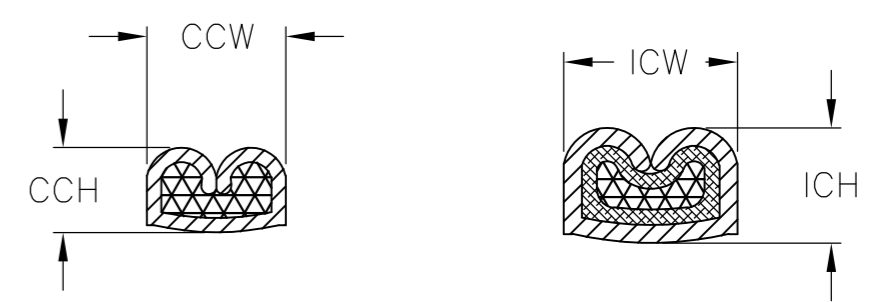

	3-1438230-3	12	12	3.25	2.00	3.20	3.50	-	-
	3-1438230-2	14	14	2.85	1.80	3.20	2.90	3.40	3.05
	3-1438230-1	22	22	1.85	1.20	2.20	2.00	2.40	2.15
			24	1.85	1.10	2.20	1.75	2.40	1.90
3-1438230-5	3-1438230-4	18	18	2.05	1.50	2.40	2.30	2.80	2.70
			20	2.05	1.40	2.40	2.20	2.80	2.60
TYCO ELECTRONICS REWOUND P/N	TYCO ELECTRONICS P/N	GRIP CODE	WIRE SIZE	CCW	CCH	ICW	ICH	ICW	ICH
				CONDUCTOR CRIMP		INSULATION CRIMP (TW)		INSULATION CRIMP (STD)	

THIS DRAWING IS A CONTROLLED DOCUMENT.

DIMENSIONS: mm	TOLERANCES UNLESS OTHERWISE SPECIFIED:	DWN JR BUSSARD 09 MAY 2003	Tyco Electronics Corporation Harrisburg, PA 17105-3608
	0 PLC ± -	CHK DM REVAK 09 MAY 2003	
	1 PLC ± -	APVD DM REVAK 09 MAY 2003	
	2 PLC ± -	PRODUCT SPEC	
MATERIAL SEE NOTES	FINISH SEE NOTES	WEIGHT -	NAME: TERMINAL - WIRE SNAP ON FEMALE SIZE: A2 CAGE CODE: 00779 DRAWING NO: C-1438230 RESTRICTED TO: - SCALE: 5:1 SHEET: 1 of 1 REV: D

CUSTOMER DRAWING