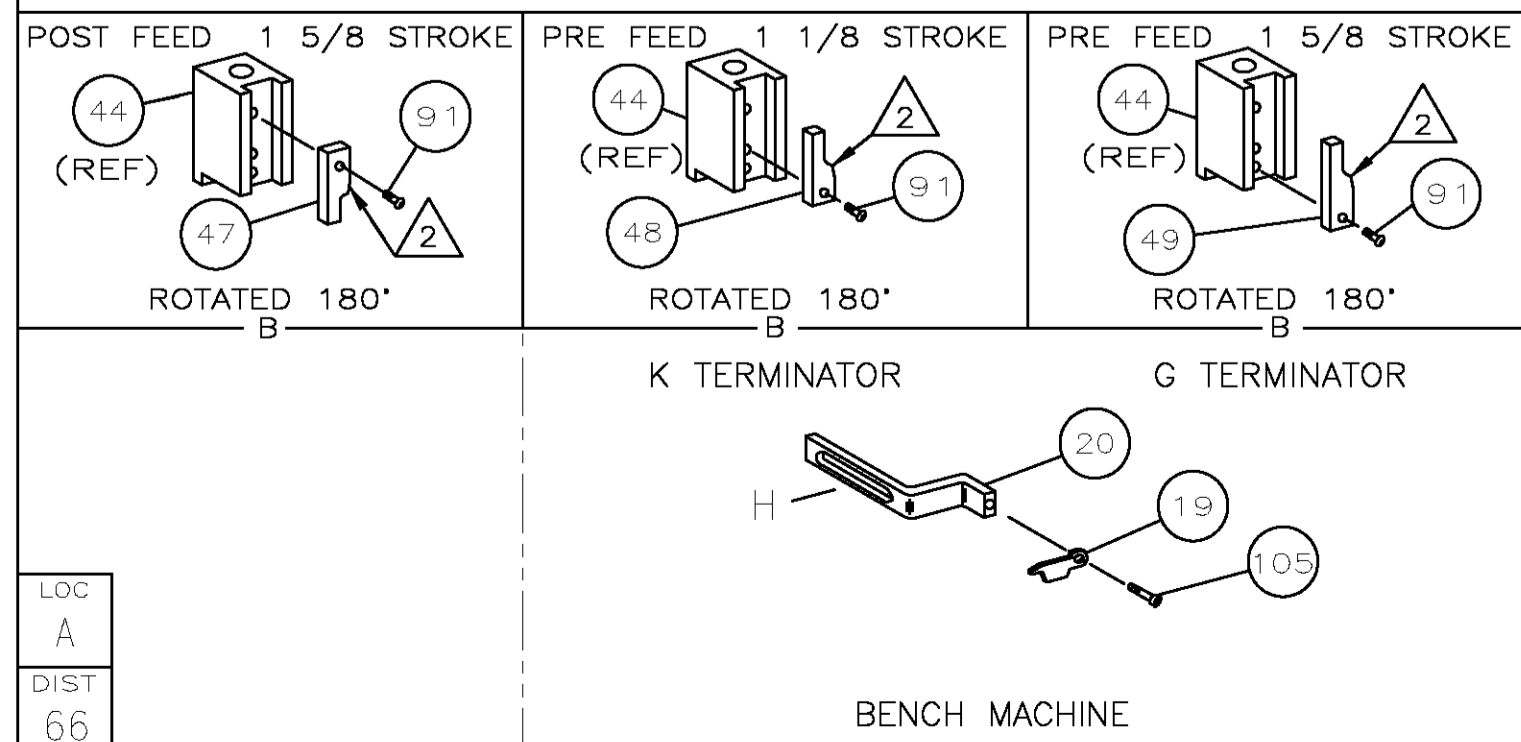
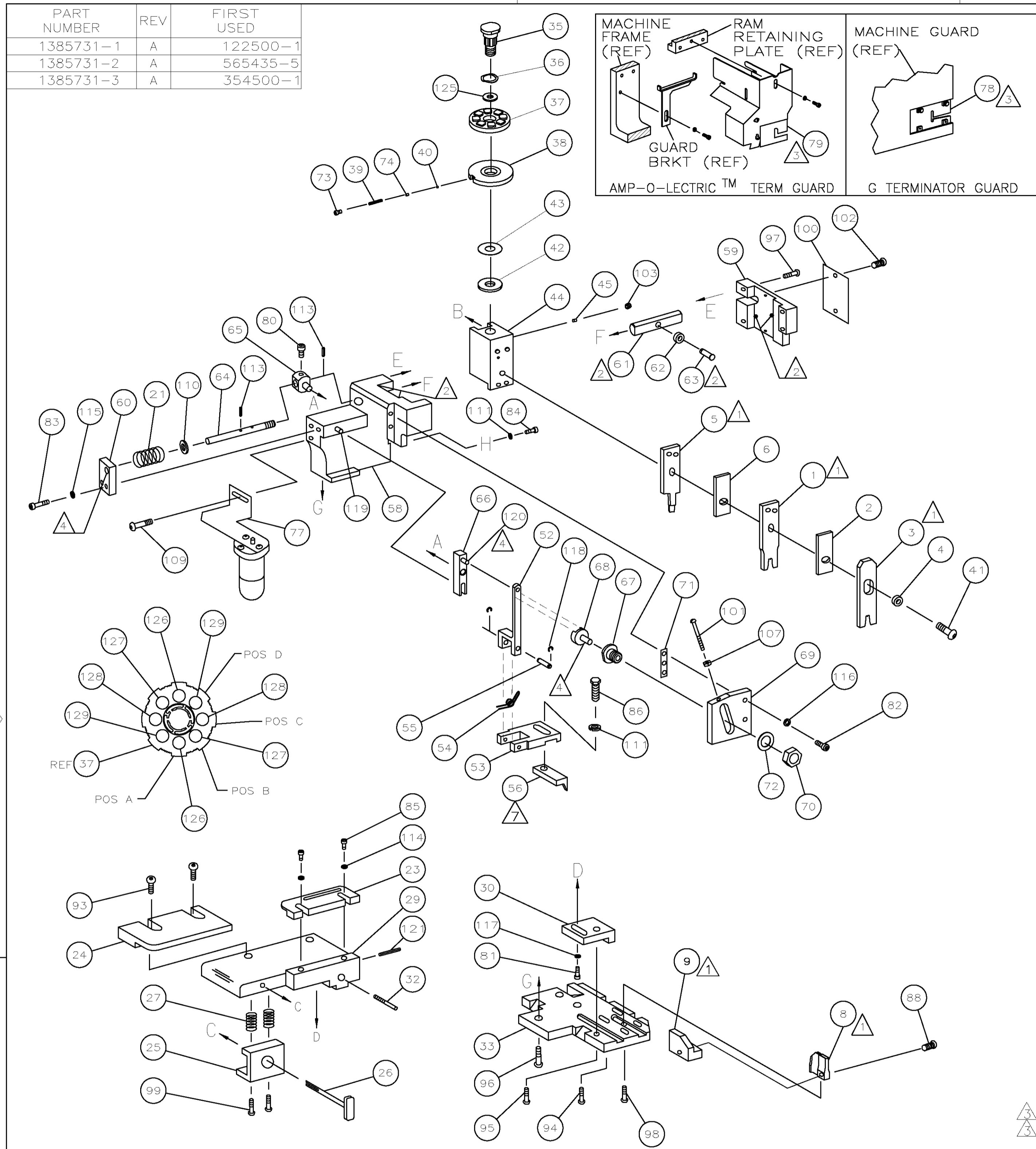

Table with 3 columns: PART NUMBER, REV, FIRST USED. Rows 1385731-1, 1385731-2, 1385731-3.



- 1 RECOMMENDED SPARE PARTS.
2 GREASE LIGHTLY.
3 GUARD MUST BE IN PLACE WHEN OPERATING APPLICATOR IN A BENCH MACHINE.
4 LUBRICATE DAILY USING NO. 20 MACHINE OIL.
5. ITEMS WITH QTY OF REF SPECIFIED (EXCEPT ITEMS 78 AND 79) ARE USED ON ITEM 46.
6. TERMINALS REQUIRE LUBRICATION.
7 DO NOT GUIDE FEED PAWL IN SLOT

Terminal Name: MOLEX .156 PITCH KK TERMINAL. Tables for CRIMP DATA (MOLEX TERMINAL-MOLEX SPEC), CRIMP SIZE, TYPE, RANGE, WIRE STRIP LENGTH, TERM APPL SPEC, FEED, APPL INSTRUCTION, SET UP GAGE, LAYOUT.

Parts List table with columns: QTY, RECD PER ASSY, PART NO, DESCRIPTION, ITEM NO. Lists various components like pins, washers, springs, and guides.

Revision table with columns: REV, LEADMAKER, MECH POST FEED, BENCH MODEL, MECH PRE FEED. Lists revisions from -1 to -3 with descriptions of changes.

Technical specifications including DIMENSIONS IN INCHES, TOLERANCES, DR B:HIGMAN, CHK 15MAR04, NAME SIDE FEED HDM APPLICATOR, SCALE, DWG NO 1385731, SHEET 1 OF 1, REV A2.

THIS DRAWING IS A CONTROLLED DOCUMENT.

THIS DRAWING IS UNPUBLISHED. RELEASE FOR PUBLICATION BY AMP INCORPORATED. ALL RIGHTS RESERVED. 1385731