

BUMPERS AND FEET



RBS

MOULDED BUMPERS



Part No.	Diameter Ø mm	Height mm	Std. Pk.	Carton qty.	Standard-Colour
RBS-1	12.7	3.5	200	5.000	CL, BLK, WH, BR, GR
RBS-5	12.7	1.6	200	5.000	CL, BLK
RBS-6	12.7	6.3	200	5.000	CL, BLK
RBS-11	15.9	10.1	128	2.560	CL, BLK
RBS-18	12.7	3.5	200	5.000	CL, BLK
RBS-24	20.5	3.1	72	2.520	CL, BLK, WH
RBS-34	9.5	3.1	300	6.000	CL, BLK
RBS-35	9.5	4.8	200	5.000	CL, BLK
RBS-41	20.0	5.1	72	3.360	CL, BLK
RBS-44	19.1	4.1	98	2.450	CL, BLK

RBS-1

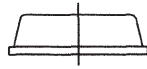

RBS-5



RBS-6

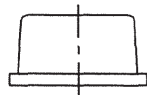

RBS-11

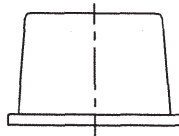

RBS-34



RBS-18

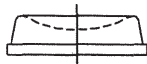

RBS-41

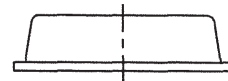

RBS-35

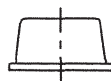

RBS-24

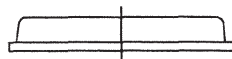

RBS-44

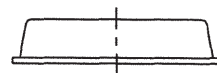

Colour Code Guide	
Colour	Code
clear	CL
black	BLK
white	WH
brown	BR
grey	GR

Note:

RBS	1	CL
Part	Type	Colour Code

Other Colours available by special order.

Material: Polyurethane, UL 94 HB, Shore A 60-70, RMS-64
 Tape: transparent Tape: Synthetic Rubber, RMS-68
 colour Tape: Acrylic, RMS-65
 Std. Pk.: see table