

**Specification Status: Released**

**Maximum Operating Voltage:** 60V<sub>DC</sub>

**Fault Ratings at 20°C:**  
250 V<sub>RMS</sub>, 3A, 10 applications  
600 V<sub>RMS</sub>, 1A, 5 applications

- Additional Info at 20°C:**
- Resistance matched: N/A
  - Lightning withstand: 1.5kV per ITU-T
  - Helps equipment meet ITU-T K.20, K.21 Recommendations
  - Helps equipment meet Telcordia GR1089 intrabuilding requirements

**Terminal Material:** Tin-Plated Brass

**Marking:**

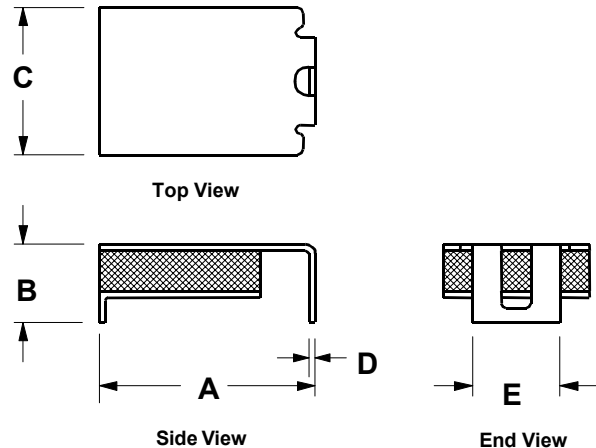
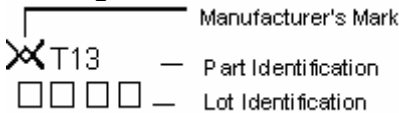

**TABLE I. DIMENSIONS:**

	A		B		C		D	E
	MIN	MAX	MIN	MAX	MIN	MAX	NOM	NOM
mm:	8.5	9.4	--	3.4	--	7.4	0.3	3.8
in.*	(0.335)	(0.370)	--	(0.135)	--	(0.290)	(0.011)	(0.150)

\*Rounded off approximation

**TABLE II. PERFORMANCE RATINGS @ 20°C:**

HOLD CURRENT (A)	TRIP CURRENT (A)	RESISTANCE (Ω)			TIME TO TRIP (Sec) @ 1A		OPERATING TEMPERATURE (°C)		TRIPPED POWER DISSIPATION (W) TYP @ 60V <sub>DC</sub>
		R MIN	R MAX	R <sub>1MAX</sub> *	TYP	MAX	MIN	MAX	
0.130	0.260	6.5	12.0	20.0	0.9	2.5	-40	85	1.1

\*Maximum device resistance at 20°C measured 1 hour post trip and 24 hours post reflow

**TABLE III. APPLICABLE PART DESCRIPTIONS:**

PART DESCRIPTION	PACKAGING TYPE	NOTE
TS250-130F-2	Tape and Reel	N/A

Agency Recognitions:	UL (File #E74889), CSA (File #78165C), TUV
Reference Documents:	Raychem PS300, ITU-T K.20, K.21
Precedence:	This specification takes precedence over documents referenced herein.
Effectivity:	Reference documents shall be the issue in effect on the date of invitation for bid.
Caution:	Operation beyond the rated voltage or current may result in rupture, electrical arcing or flame.

**Materials Information**

**ROHS Compliant**      **ELV Compliant**      **Pb-Free**

