

LXML-NX02 Product Brief

Side-emitter lens

Introduction

The LXML-NX02 side-emitter lens has been designed to operate with the entire family of LUXEON Rebel lambertian emitters and distribute the light from the side of the secondary lens.

The design and use of a precision-injection molding, optical grade material system, delivers high coupling efficiencies from the LED source in to the intended application.



Features

- Operating temperature up to 60°C
- Up to 90% efficiency
- Operates with all LUXEON Rebel LED emitters
 - Cool-White, Neutral-White, Warm-White
 - Green, Cyan, Blue, Royal-Blue
 - Red, Red-Orange, Amber
- Optical grade cyclo-olefin polymer (COP) material
-

Typical Applications

- Portable Lighting (flashlights/torch, bicycle)
- Interior reading lights (car, bus, aircraft)
- Task Lighting
- Accent, Decorative, Fiber optic alternative
- Indoor/outdoor commercial and residential
- Architectural Lighting

Absolute Maximum Ratings

| Parameter | Minimum | Maximum |
|-----------------------|---------|---------|
| Operating Temperature | 10 °C | 60 °C |
| Storage Temperature | -40 °C | 100 °C |

Mechanical Outline Dimensions

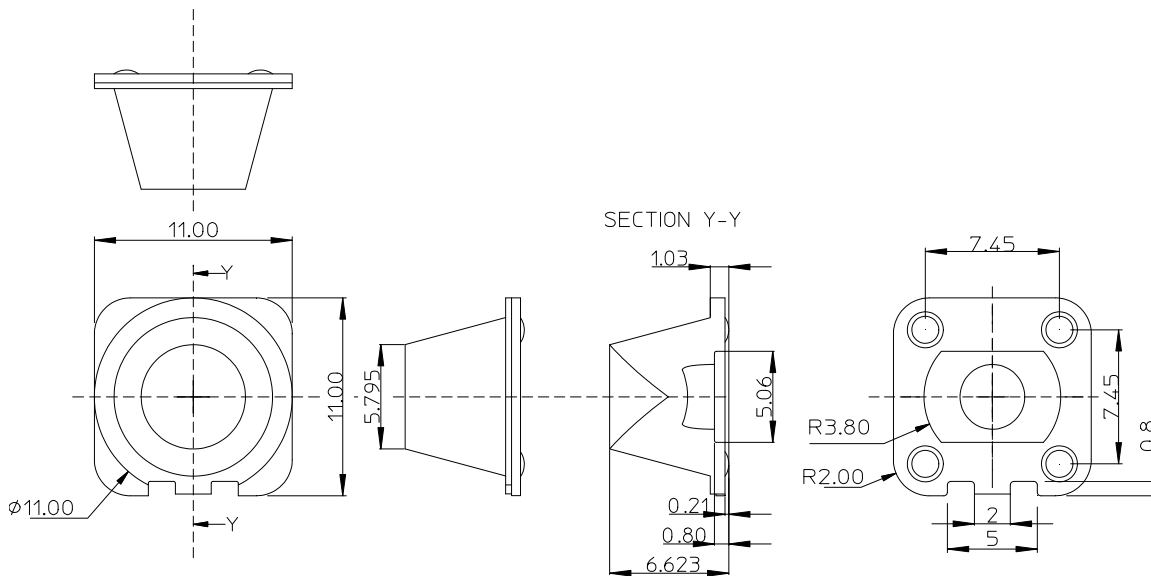

Notes:

1. Drawings not to scale.
2. All dimensions are in millimeters.
3. All dimensions without tolerances are for reference only.

Typical Radiation Pattern

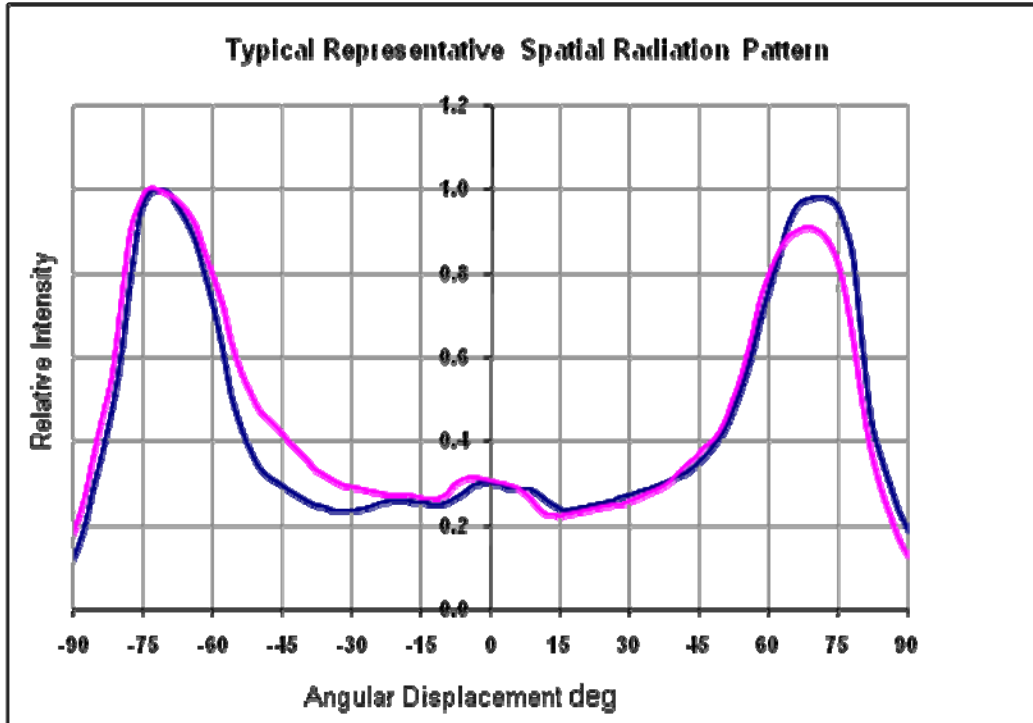



Company Information

Philips Lumileds Lighting Company is a world class supplier of Light Emitting Diodes (LEDs) and produces billions of LEDs annually. Philips Lumileds is a fully integrated supplier producing core LED material in all three base colors (red, green, blue) and white. Philips Lumileds has R&D centers in San Jose, California and in The Netherlands as well as production capabilities in San Jose, Penang Malaysia and Singapore. Founded in 1999, Philips Lumileds is the high-flux LED technology leader and is dedicated to bridging the gap between solid-state LED technology and the lighting world. Philips Lumileds technologies, LEDs and systems are enabling new applications and markets in the lighting world.

Philips Lumileds may make process or materials changes affecting the performance or other characteristics of our products. These products supplied after such changes will continue to meet published specifications, but may not be identical to products supplied as samples or under prior orders.



WWW.LUXEON.COM
WWW.LUMILEDSFUTURE.COM

FOR TECHNICAL ASSISTANCE OR THE LOCATION OF YOUR NEAREST SALES OFFICE CONTACT ANY OF THE FOLLOWING:

NORTH AMERICA:
1 888 589 3662
AMERICAS@FUTURELIGHTINGSOLUTIONS.COM

EUROPE:
00 800 443 88 873
EUROPE@FUTURELIGHTINGSOLUTIONS.COM

ASIA PACIFIC:
800 5864 5337
ASIA@FUTURELIGHTINGSOLUTIONS.COM

JAPAN:
800 5864 5337
JAPAN@FUTURELIGHTINGSOLUTIONS.COM