



# Fortimo LED downlight module (US)

Fortimo LED DLM 2000 25W/835 UL Gen3

Fortimo LED downlight modules offer breakthrough energy efficient white light based on the latest LED technology. The modules incorporate special Fortimo phosphor technology enabling a very high lm/W performance. They are intended to be built in to luminaires for use in general lighting applications, primarily downlighting. As energy efficacy advances in LEDs are made and new bins become available, these are incorporated in to the modules, continuously offering higher efficacies, without changing the dimensions, shape or lumen output of the module. This future proof design of the DLM module enables luminaire manufacturers to plan and design new luminaire ranges for the coming years.

## Product data

### • General Characteristics

Life to 70% lumen maintenance 50000 hr

### • Light Technical Characteristics

Color Code 835  
 Correlated Color Temperature 3500 K  
 Luminous Flux 2000 Lm  
 Color rendering index 80  
 Color consistency initial 3

### • Electrical Characteristics

Wattage 25 W  
 Power module 25 W  
 Module input voltage 120-277 V

### • Temperature Characteristics

T-case maximum 65 C  
 T-ambient -20 (min) C

### • Product Dimensions

Length A1 81.6 mm

Length A3 66.8 mm  
 Width B1 82.8 mm  
 Height C1 43.7 mm  
 Height C2 40.2 mm

### • Approval & Application Chars

UL certificate Yes  
 RoHS compliance Yes

### • Product Data

Order code 929000672003  
 Full product code 929000672003  
 Full product name Fortimo LED DLM 2000 25W/835 UL Gen3  
 Order product name Fortimo LED DLM 2000 25W/835 UL Gen3  
 Pieces per pack 1  
 Packing configuration 6  
 Packs per outerbox 6  
 Bar code on pack - EAN1 8718291169932  
 Bar code on outerbox - EAN3 8718291169949  
 Logistic code(s) - 12NC 929000672003  
 Net weight per piece 0.290 kg

## Dimensional drawing

## Dimensional drawing

### Fortimo LED downlight module

Product	A1 (Norm)	A3 (Norm)	B1 (Norm)	C1 (Norm)	C2 (Norm)
Fortimo LED DLM 2000 25W/835 UL Gen3	81.6	66.8	82.8	43.7	40.2

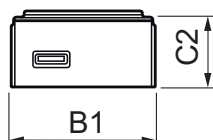
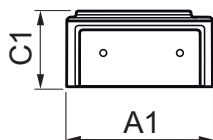
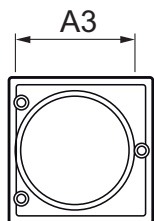

© 2012 Koninklijke Philips Electronics N.V.  
All rights reserved.

Specifications are subject to change without notice. Trademarks are the property of Koninklijke Philips Electronics N.V. or their respective owners.

[www.philips.com/lighting](http://www.philips.com/lighting)

2012, August 4  
data subject to change