

Xitanium/Fortimo LED Drivers Indoor

Xitanium 75W SH 0.3-1A 110V I 230V

The new Fortimo and Xitanium electronic LED drivers are specially designed to operate LED solutions for general lighting applications. There are Xitanium LED driver versions in 17W / 24V, 25W / 36V and 45W / 80V. There are fixed-output and dimmable (trailing edge and Touch & DALI) versions. The high output voltage (up to 80V) and adjustable output current (200 to 700mA) enable operation of many LEDs (high light output) and flexibility in LED fixture design. The output current can be set by placing a resistor on your LED PCB (Level 2 board). The new housing design incorporates three different mounting options: independent, screw and click mounting. The 25W and 45W versions also feature a 12V output to operate active cooling or decorative LED light effects. The Xitanium LED driver 45W/80V is available in fixed-output version in an independent housing.

Product data

• General Characteristics

Input Frequency	50/60 Hz
Relative Humidity	93 (min), 98 (max) %
IP Classification	20
Lifetime 90% surv.@Tcaselife	50000 hr
System Description	I [Independent]

• Operating Characteristics

12V output	Yes
Ripple current	20 %
Efficiency Range	90-90 %
Output Power Range	21-75 W
Power Factor (100% load)	0.9 (min) -
Output Voltage Range	55-110 V
Output Current Range (mA)	300-1000
Total Harmonic Distortion IEC	20 (max) %
Input Voltage Range (DC)	186-254 V
Inrush Current Peak	48 (max) A
Output Current Tolerance	-5 (min), 5 (max) %
Inrush Current	180 us
Width to 50%	
Type of Dimming	None
Input Voltage Range (AC)	220-240 V
Earth leakage current	0.7 (max) mA
Max drivers on MCB(16A type-B)	12 (max) x

• Wiring Characteristics

Connection on driver to L2	JST connector
Hot wiring	Yes
Connector type input terminal	Wago 804
Connector type output terminal	Wago 250

• Temperature Characteristics

T-case Lifetime	75 C
T-case maximum	75 (max) C
T-ambient	-20 (min), 50 (max) C
T-storage	-25 (min), 85 (max) C

• Product Dimensions

Length A1	192.7 mm
Width B1	83 mm
Height C1	34.5 mm
Fixing Hole Diameter D1	4.1 mm

• Approval & Application Chars

Isolation classification	SELV
ENEC certificate	Yes
CE marking	Yes

• Product Data

Order code	929000617503
Full product code	929000617503
Full product name	Xitanium 75W SH 0.3-1A 110V I 230V

PHILIPS

sense and simplicity

Titanium/Fortimo LED Drivers Indoor

Order product name Xtanium 75W SH 0.3-1A 110V I
230V
Pieces per pack 1
Packing configuration 6
Packs per outerbox 6
Bar code on pack - 8718291129417
EAN1

Bar code on 8718291129417
outerbox - EAN3
Logistic code(s) - 929000617503
12NC
Net weight per piece 0.341 kg

Dimensional drawing

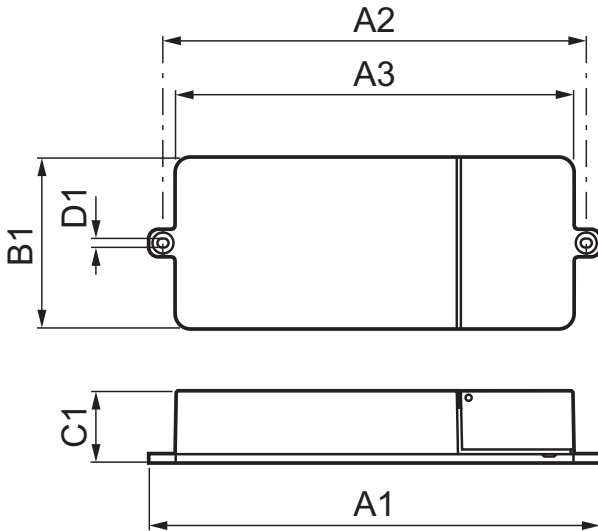

Xtanium 75W SH 0.3-1A 110V I 230V

Product	A1 (Norm)	A2 (Norm)	A3 (Norm)	B1 (Norm)	C1 (Norm)	D1 (Norm)
Xtanium 75W SH 0.3-1A 110V I 230V	192.7	-	-	83	34.5	4.1

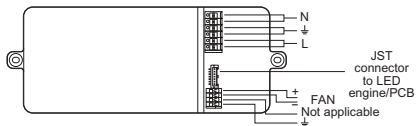

Xtanium 75W SH 0.3-0.1A I



© 2013 Koninklijke Philips Electronics N.V.
All rights reserved.

Specifications are subject to change without notice. Trademarks are the property of Koninklijke Philips Electronics N.V. or their respective owners.

www.philips.com/lighting

2013, January 24
data subject to change