



LED Power Driver 20 W

LED outdoor applications

Philips LED Power driver range

designed for a wide variety of outdoor lighting applications



LED Power Driver 60 W

Philips LED Power Drivers have a universal mains input (100-240 V) and generate a 24 VDC or 12 VDC voltage. The LED Power Drivers have an operating life matching that of LEDs. The range consist of a slim 20 W version with a plastic housing and 60 and 100 W versions with a metal housing. All three types have been tested according IP66.

Description

Philips LED Power Drivers perfectly operate the Philips LED based systems including:

- LED String Generation 2 - a wire connected string of LEDs for safer, more energy efficient signs and architectural effects.
- The LED Module System - lighting blocks that can be joined in a flexible “domino” like arrays to produce creative luminaires and displays.
- LED Rigid Strips.

Independent

60W-24V also has independent version for the use of the outside of the fixture.

Excellent reliability

LED Power Drivers last up to 50,000 hours, to take advantage of the long life of LEDs. They come with the Philips electronic ballast guarantee.

Low-temperature performance (-30 °C)

So you can be confident in any outdoor application (tested according IP66).

Hazard-free & universal mains (100-240 V)

All major safety requirements (as defined in CE, UL, CSA and VDE) are met.

Furthermore all three types come in universal mains, so you can install them in practically any location.

Improved safety

Philips LED Power Drivers generate a limited output voltage and also provide isolation for safe operation (SELV).

Typical applications include

- Channel letter/contour lighting
- Architectural lighting
- Retail/theme lighting
- Orientation lighting
- Entertainment lighting
- Emergency and security lighting

Compliance and approvals

- CE
- UL
- CSA
- VDE



LED Power Driver 100 W

PHILIPS

sense and simplicity

Product Specifications

Input						
Parameter	Symbol	20W-24V driver	60W-24V driver	100W-24V driver	60W-12V driver	Unit
Input voltage range	V_{in}	100-240	100-240	100-240	100-240	V
Frequency	f	47-63	47-63	47-63	47-63	Hz
Power consumption range	P_{in}	25 max.	75 max.	120 max.	75 max.	W
Power factor	Pf	0.9 min	0.9 min	0.9 min	0.9 min	
Total harmonic distortion	THD	20	20	20	20	%
Efficiency	-	80% typical	80% typical	80% typical	80% typical	%

Output						
Parameter	Symbol	20W-24V driver	60W-24V driver	100W-24V driver	60W-12V driver	Unit
Output voltage range	V_{in}	23-25.6	23-25.6	23-25.6	11.4-12.6	V
Output current	I_a	0.85	2.5	4.1	5.0	A
Output voltage ripple	-	1.0	1.0	1.0	1.0	%
Short circuit protection	-	yes	yes	yes	yes	-

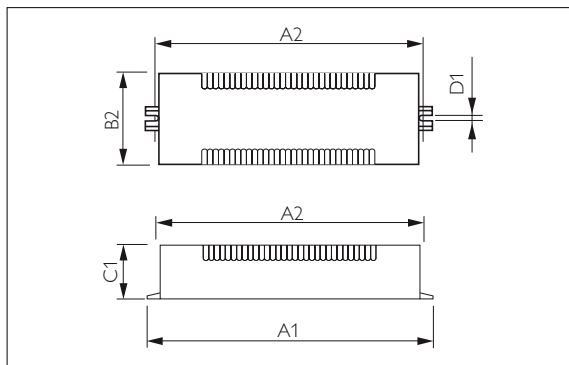

Dimensions Philips LED Power Driver 20 W.

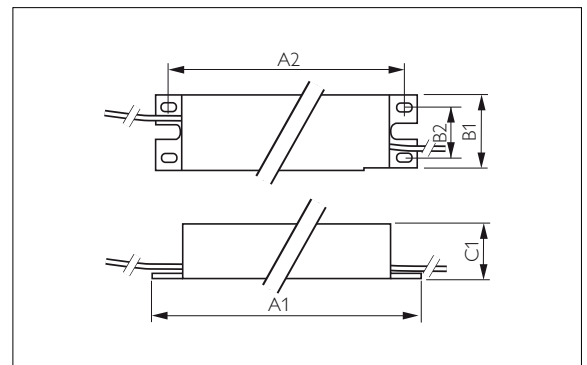

Dimensions Philips LED Power Driver 60 W. & 100 W

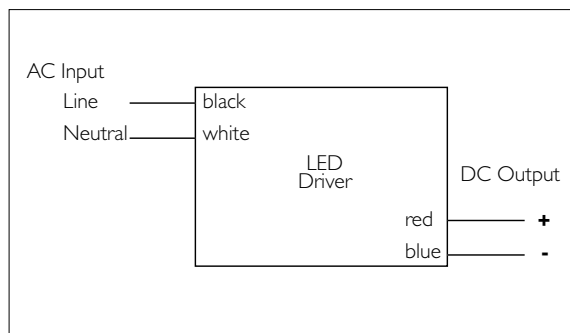

Wiring diagram of the 20 W, 60 W & 100 W LED Power Driver.

Dimensions in mm

Driver type	A1	A2	B1	B2	C1	D1
20W	140.0	130.0	37.0	18.5	25.0	4.4
60W	228.6	141.3	43.1	26.6	30.0	4.4
100W	228.6	141.3	43.1	26.6	30.0	4.4

Notes:

1. Drawings are not to scale.
2. Two mounting slots for M4 or #6 screws.
3. Lead wires: 300 mm length, 0.8 mm² solid-core copper.

Ordering info

Type	Carton packaging	12NC Order number	European Order Code (EOC)
			87115 00
100-240V 20W-24V	10	9137 006 20891	911940 30
100-240V 60W-24V	10	9137 006 20991	911469 30
100-240V 100W-24V	10	9137 006 21091	911964 30



© 2009 Koninklijke Philips Electronics N.V.

All rights reserved. Reproduction in whole or in part is prohibited without the prior written consent of the copyright owner. The information presented in this document does not form part of any quotation or contract, is believed to be accurate and reliable and may be changed without notice. No liability will be accepted by the publisher for any consequence of its use. Publication thereof does not convey nor imply any license under patent- or other industrial or intellectual property rights.

Document order number: 3222 635 72681
10/2009

www.philips.com/xitanium
www.philips.com/LED