

SERIES 1257 - DOUBLE-POLE ROCKER SWITCHES

TO 8 (8) A 250 V AC

PRODUCT FEATURES

- ◆ Double-pole OFF switch
- ◆ Powerful up to 14 A (UL) and 100 000 mechanical switching cycles
- ◆ Dust protected

ON REQUEST

- ◆ Other colors
- ◆ Other connection variants
- ◆ Without interference suppression capacitor
- ◆ Higher ratings up to 12 (12) A

Mechanical life endurance	10E4
Actuator	IP 40
Material actuator housing	PA glass fiber-reinforced PA glass fiber-reinforced
Interference suppressor	C = 0.22 µF 275 V AC
Approval marks	



double-pole	Actuator color / printing	Housing color	8 (8) A 250 V AC 5E4	16 A 125 - 250 V AC	14 A 125 - 250 V AC	250 V AC 1 1/2 HP	125 V AC 3/4 HP	Connection type	Connection description	Contact distance in mm	Contact material	Stock version
ON/OFF switch (DPST)												
1257.0101			●	●	●	●	●		2 x 6.3 x 0.8 2 x M4 Torx	± 0.3	Ag	



Basic type 1257

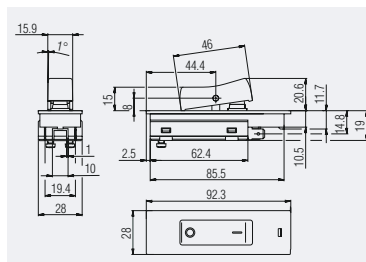

Quick-connect terminal motor side, socket terminal mains side

ROCKER SWITCHES

PUSHBUTTON SWITCHES

TOGGLE SWITCHES

SLIDE SWITCHES

ROTARY SWITCHES

FOOT SWITCHES

POWER TOOL SWITCHES

TACT AND KEY SWITCHES

SNAP-ACTION SWITCHES

MICRO-SIGNAL SWITCHES

SENSORS