

# Major League Electronics .200 cl Terminal Strip Header - Right Angle

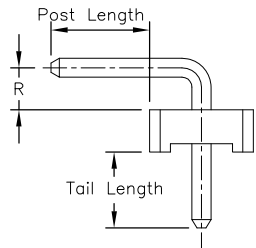
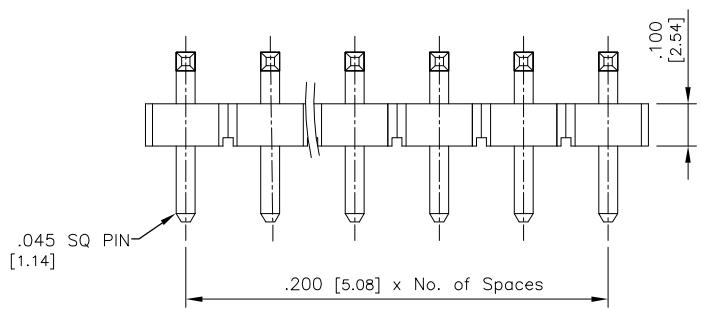
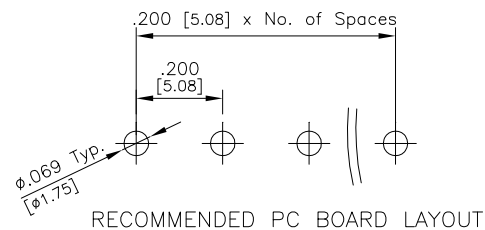
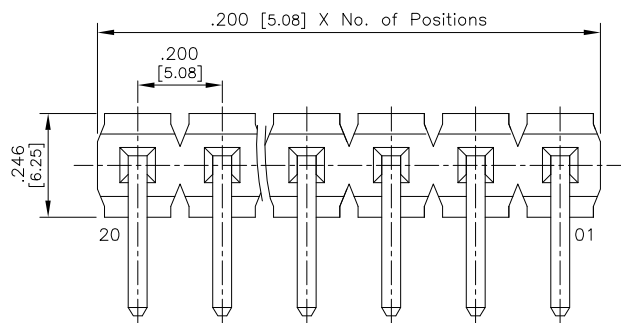

Tails may be clipped to achieve desired pin length

## Ordering Information

PC200HR  - S -  - T - LF

Pins Per Row  - 02 - 20  
 Row Specification S = Single Row  
 Lead Free

Plating Options	
T	Matte Tin All Over

Pin Options						
Post Length		Tail Length		R Dimension		
.318	8.08mm	.180	4.57mm	.100	2.54mm	06
.544	13.82mm	.156	3.96mm	.195	4.95mm	14

## Specifications

- Current Rating: 7.9 Ampere
- Insulation Resistance: 5000MΩ Min.
- Dielectric Withstanding: 1500V AC/DC
- Contact Resistance: 20 mΩ Max.
- Operating Temperature: -55°C to + 125°C
- Max. Process Temperature:
  - IR Reflow: 280°C up to 10 secs.
  - Wave: 250°C up to 10 secs.
  - Manual Solder: 380°C up to 5 secs.

## Materials

- Contact Material: Brass
- Insulator Material: LCP, UL94V-0
- Plating: 120μ" Matte Tin over 50μ" (1,27) Ni

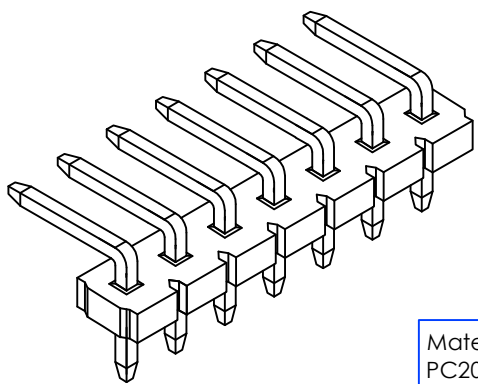

Mates with:  
 PC200S-XX-S-02  
 PC200S-XX-S-04

Products cut to specific sizes are uncancellable/nonreturnable      Parts are subject to change without notice

UNLESS OTHERWISE SPECIFIED  
 DIMENSIONS IN INCHES (MM)  
 TOLERANCES ARE:  
 ONE PLACE DECIMALS ±0.38  
 TWO PLACE DECIMALS ±0.25  
 THREE PLACE DECIMALS ±0.13  
 ANGLES  
 NO PLACE DECIMALS ±4.0°  
 ONE PLACE DECIMALS ±3.0°  
 TWO PLACE DECIMALS ±2.0°  
 THREE PLACE DECIMALS ±1.0°

<b>PC200HR SERIES</b>	.200cl Single Row - Right Angle Thru Hole Terminal Strip Header	<b>23 JUN 08</b>	Scale NTS
		4235 Earnings Way, New Albany, Indiana, 47150, USA 1-800-782-3486 (USA/Canada/Mexico) Tel: 812-944-7244 Fax: 812-944-7268 E-mail: mle@mlelectronics.com Web: www.mlelectronics.com	
		Edition 1	Sheet 1/1