

Ordering number CA10315_APOLLO-SS

Family	Apollo-(sputnik)	FWHM	9 degrees
Type	Assembly	Efficiency	(simulated) 0 %
LED	LUXEON K2	cd/lm	23.290
Color	Clear	Gerber File	Available
Diameter	26 mm		
Height	17.2 mm		
Style	Round		
Optic Material	PMMA		
Holder Material	-		
Fastening	Tape		
Status	Ready		

Ordering number CA10251_APOLLO-M

Family	Apollo-(sputnik)	FWHM	25 degrees
Type	Assembly	Efficiency	(simulated) 0 %
LED	LUXEON K2	cd/lm	4.260
Color	Clear	Gerber File	Available
Diameter	26 mm		
Height	17.2 mm		
Style	Round		
Optic Material	PMMA		
Holder Material	-		
Fastening	Tape		
Status	Ready		

Ordering number CA10316_APOLLO-O

Family	Apollo-(sputnik)	FWHM	35+8 degrees
Type	Assembly	Efficiency	(simulated) 0 %
LED	LUXEON K2	cd/lm	7.570
Color	Clear	Gerber File	Available
Diameter	26 mm		
Height	17.2 mm		
Style	Round		
Optic Material	PMMA		
Holder Material	-		
Fastening	Tape		
Status	Ready		

Ordering number CA10243_APOLLO-W

Family	Apollo-(sputnik)	FWHM	67 degrees
Type	Assembly	Efficiency	(simulated) 0 %
LED	LUXEON K2	cd/lm	0.560
Color	Clear	Gerber File	Available
Diameter	26 mm		
Height	17.2 mm		
Style	Round		
Optic Material	PMMA		
Holder Material	-		
Fastening	Tape		
Status	Ready		



PRODUCT DATASHEET
Apollo-(sputnik) series
last update 30/4/2013

PHILIPS
LUMILEDS

NOTE: The typical divergence will be changed by different color, chip size and chip position tolerance. The typical total divergence is the full angle measured where the luminous intensity is half of the peak value.



PRODUCT DATASHEET Apollo-(sputnik) series

last update 30/4/2013

PHILIPS
LUMILEDS

GENERAL INFORMATION

- Product series especially designed & optimized for LUXEON K2 series of LEDs.
- Special care taken to make light distribution as uniform as possible.
- Lens material optical grade PMMA with high UV and temperature resistance. Allows use of high current and temperature conditions.

Please find more information about used material from below:

http://ledil.fi/sites/default/files/Documents/Technical/Material/PMMA%20N%20UL94_Yellow%20Card.pdf

<http://ledil.fi/sites/default/files/Documents/Technical/Material/PMMA%20N%20PLEXIGLAS-Datasheet.pdf>

- Fastening to heat sink with a PU foam adhesive tape of automotive grade. Please find fastening details by clicking link: http://www.ledil.com/datasheets/DataSheet_TAPE.pdf

NOTE 1: We advise customer to ensure the suitability and sufficiency of the bond in the end product. For example, mechanical stress, vibration and holes on the surface of the circuit board weaken the strength of the tape.

NOTE 2: Assembly to the surface must be made straight, so the tape bonds constant and balanced with fastening surface. Slanted assembly might cause unbalanced bond to the surface. All surfaces where tape is applied must be clean, dry and free from grease and dirt.

If cleaning of PCB surfaces is needed, please follow strictly the cleaning instructions of your LED manufacturer - this is important as cleaning shall under no circumstances damage LEDs or other electronics components on the PCB.

Further note that optical components shall not be cleaned with any chemicals - only micro fiber cloth may be used to remove fingerprints or other traces from handling.

D

C

B

A

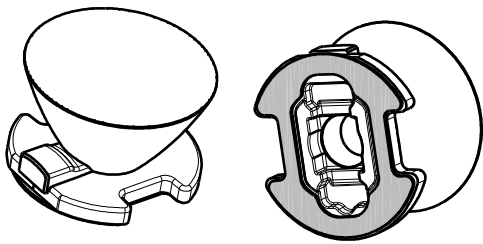

Apollo SS/M/O

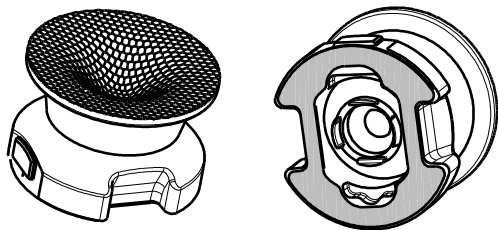

Apollo W

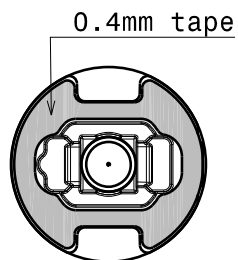

Bottom view

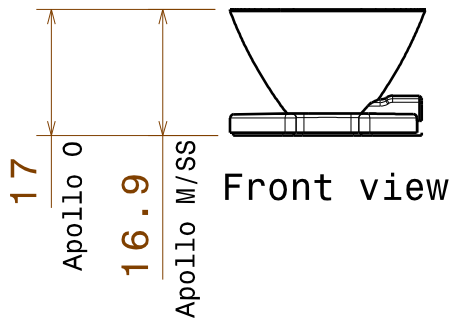
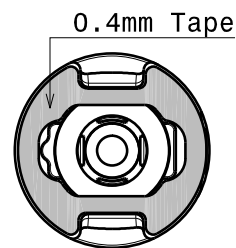

Front view

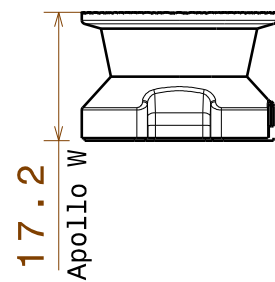

4

4

3

3

2

2

Part no.s:
 CA10243_Apollo-W
 CA10251_Apollo-M
 CA10315_Apollo-SS
 CA10316_Apollo-O
 Material: PMMA

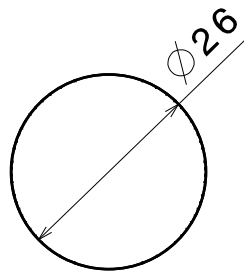

Top view

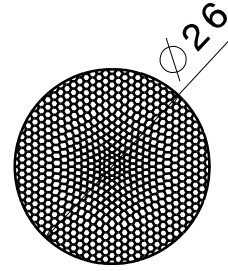

This drawing is our property.
 It can't be reproduced
 or communicated without
 our written agreement.



Ledil Oy
 Tehdaskatu 13
 FIN-24100 SALO
 Finland

DRAWING TITLE

Datasheet Apollo-series

DRAWN BY
mav

DATE
28.02.2011

CHECKED BY
HH

DATE
28.02.2011

SIZE
A4

DRAWING NUMBER
Multiple

REV
1

DESIGNED BY
HH

DATE
18.03.2006

SCALE 1:1 WEIGHT (g)

SHEET 1/1

D

A

1

1