

**Ordering number C12622\_HELENA-A**

Family	Helena	FWHM	19 degrees
Type	Lens	Efficiency	68 %
LED	LUXEON K12	cd/lm	4.000
Color	Clear	Gerber File	Available
Diameter	72.8 mm		
Height	11 mm		
Style	Round		
Optic Material	PC		
Holder Material	-		
Fastening	-		
Status	Ready		

**Ordering number C13254\_HELENA-B**

Family	Helena	FWHM	24 degrees
Type	Lens	Efficiency	74 %
LED	LUXEON K12	cd/lm	2.100
Color	Clear	Gerber File	Available
Diameter	72.8 mm		
Height	11.1 mm		
Style	Round		
Optic Material	PC		
Holder Material	-		
Fastening	-		
Status	Ready		

**NOTE: The typical divergence will be changed by different color, chip size and chip position tolerance. The typical total divergence is the full angle measured where the luminous intensity is half of the peak value.**



## PRODUCT DATASHEET

### Helena series

last update 27/2/2013

PHILIPS  
LUMILEDS

#### GENERAL INFORMATION

- Product series especially designed & optimized for LUXEON K12 series of LEDs.
- Special care taken to make light distribution as uniform as possible.
- Lens material optical grade PC with high UV and temperature resistance (120 degrees of Celcius / 248 degrees of Fahrenheit). Allows use of high current and temperature conditions.

Please find more information about used materials from below:

[http://ledil.fi/sites/default/files/Documents/Technical/Material/PC%20Makrolon%202400\\_2407\\_2456\\_2458-UL.pdf](http://ledil.fi/sites/default/files/Documents/Technical/Material/PC%20Makrolon%202400_2407_2456_2458-UL.pdf)

D

C

B

A

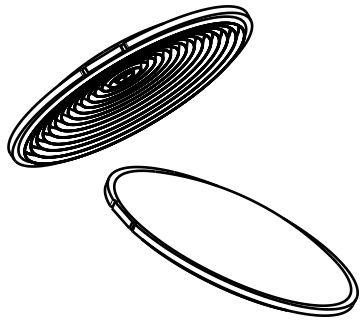

Isometric view  
Scale: 1:2

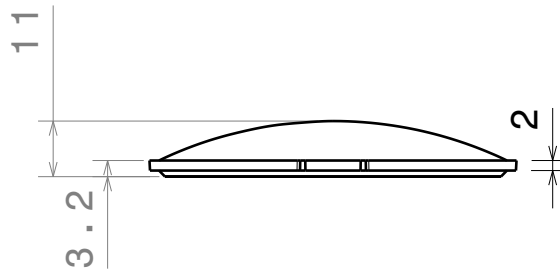

Front view

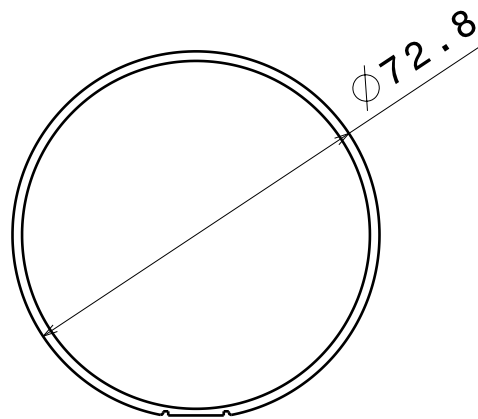

Top view

Tolerances for dimensions:  
 0-20mm tolerance value  $\pm 0.1\text{mm}$   
 21-45mm tolerance value  $\pm 0.2\text{mm}$   
 46-90mm tolerance value  $\pm 0.3\text{mm}$   
 91-100mm tolerance value  $\pm 0.4\text{mm}$   
 101-mm tolerance value  $\pm 0.5\text{mm}$

This drawing is our property.  
 It can't be reproduced  
 or communicated without  
 our written agreement.



Ledil Oy  
 Salorankatu 10  
 FIN 24240 SALO  
 Finland

DRAWING TITLE

Datasheet C12622\_HELENA-A Lens

DRAWN BY  
 mav  
 DATE  
 23.02.2012

CHECKED BY  
 pk  
 DATE  
 23.02.2012

DESIGNED BY  
 -  
 DATE  
 -

SIZE A4 DRAWING NUMBER C12622 REV 1

SCALE 1:1 WEIGHT (g) SHEET 1/1

D

A

4

4

3

3

2

2

1

1

Luminaire: LEDiL Oy C12622\_HELENA-A\_(Luxeon\_K12) Eff. 67,6%

Lamps: 1 x Luxeon K12 (797lm@250mA)

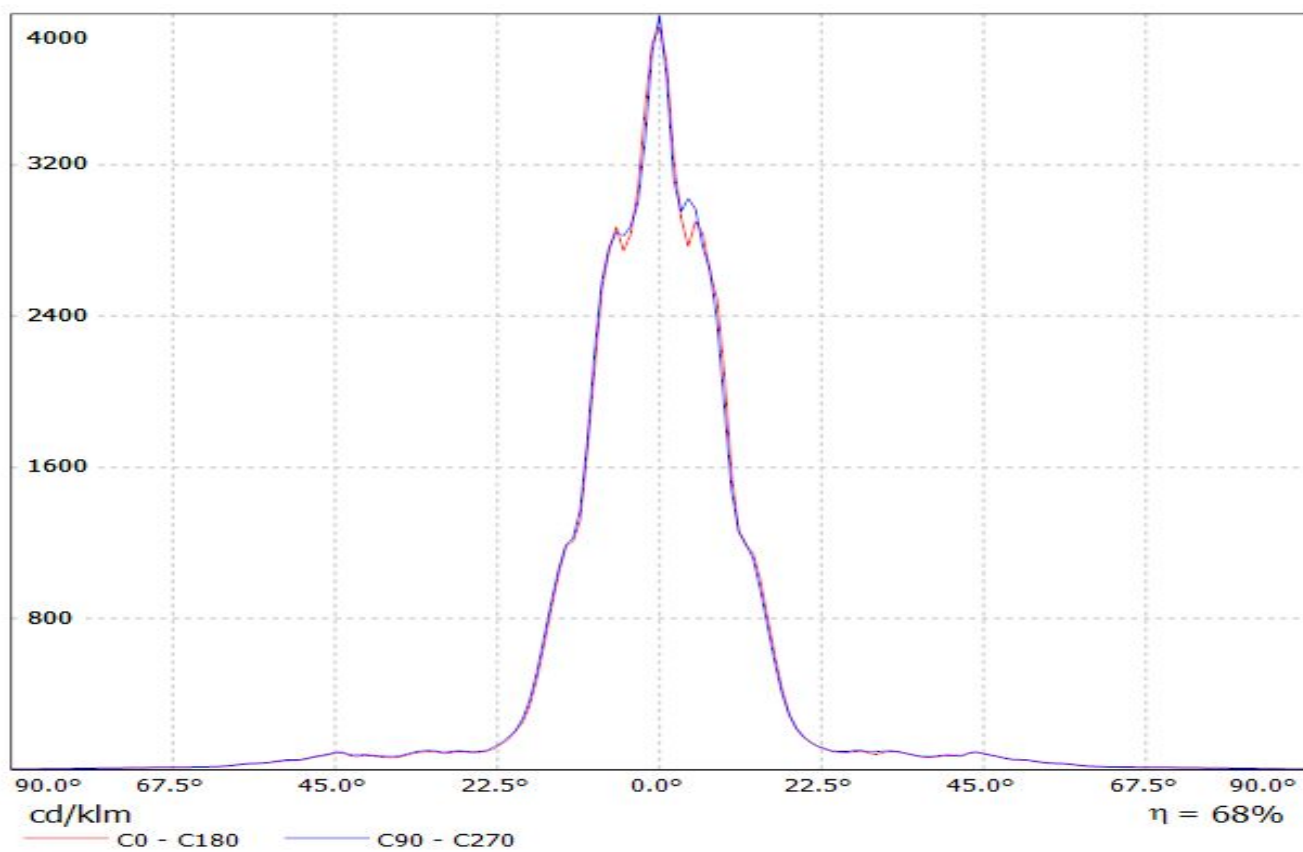

Luminaire: LEDiL Oy C13254\_HELENA-B\_(Luxeon\_K12) Eff. 73,7%  
Lamps: 1 x Luxeon K12 (797lm@250mA)

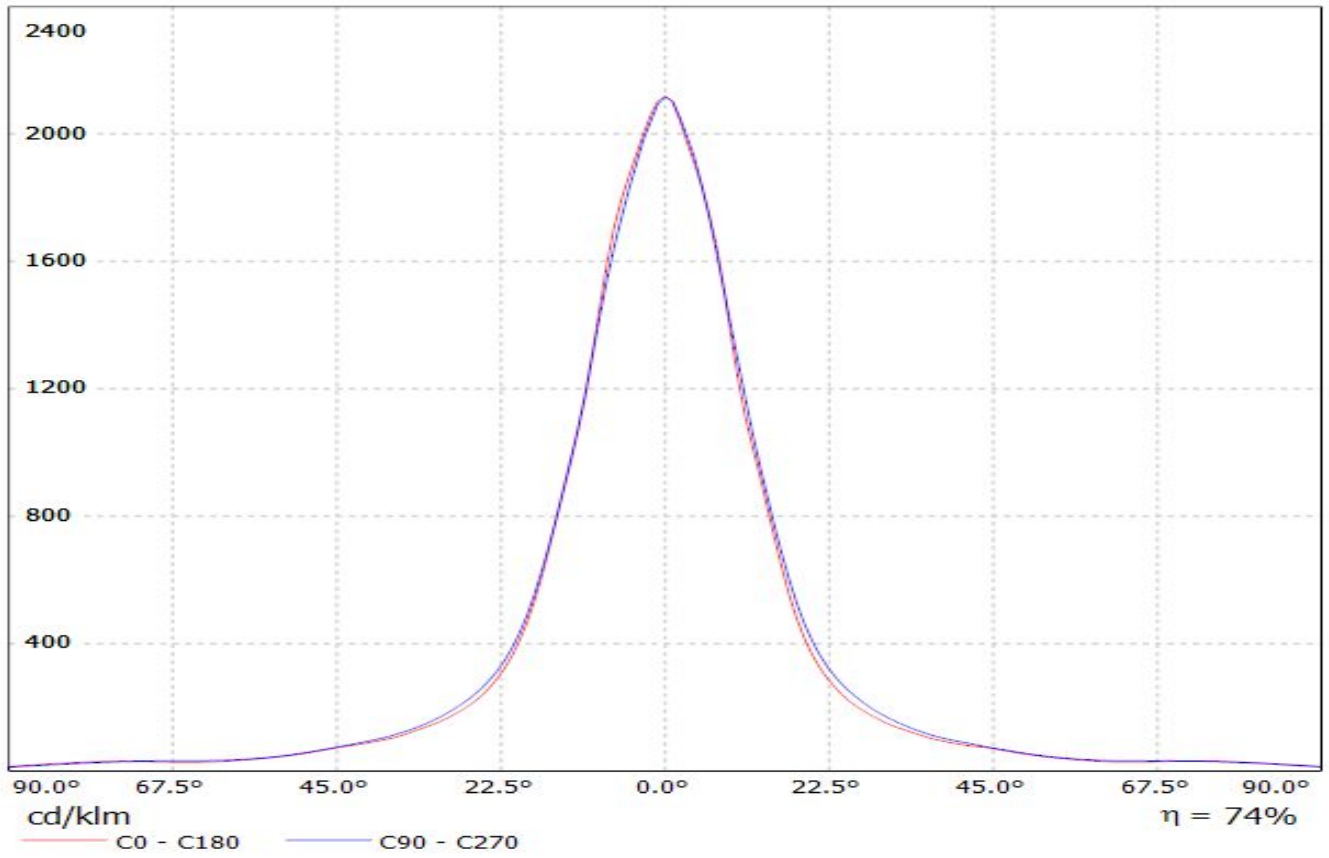

Luminaire: LEDiL Oy C12622\_HELENA-A\_(Luxeon\_K12) Eff. 67,6%  
Lamps: 1 x Luxeon K12 (797lm@250mA)

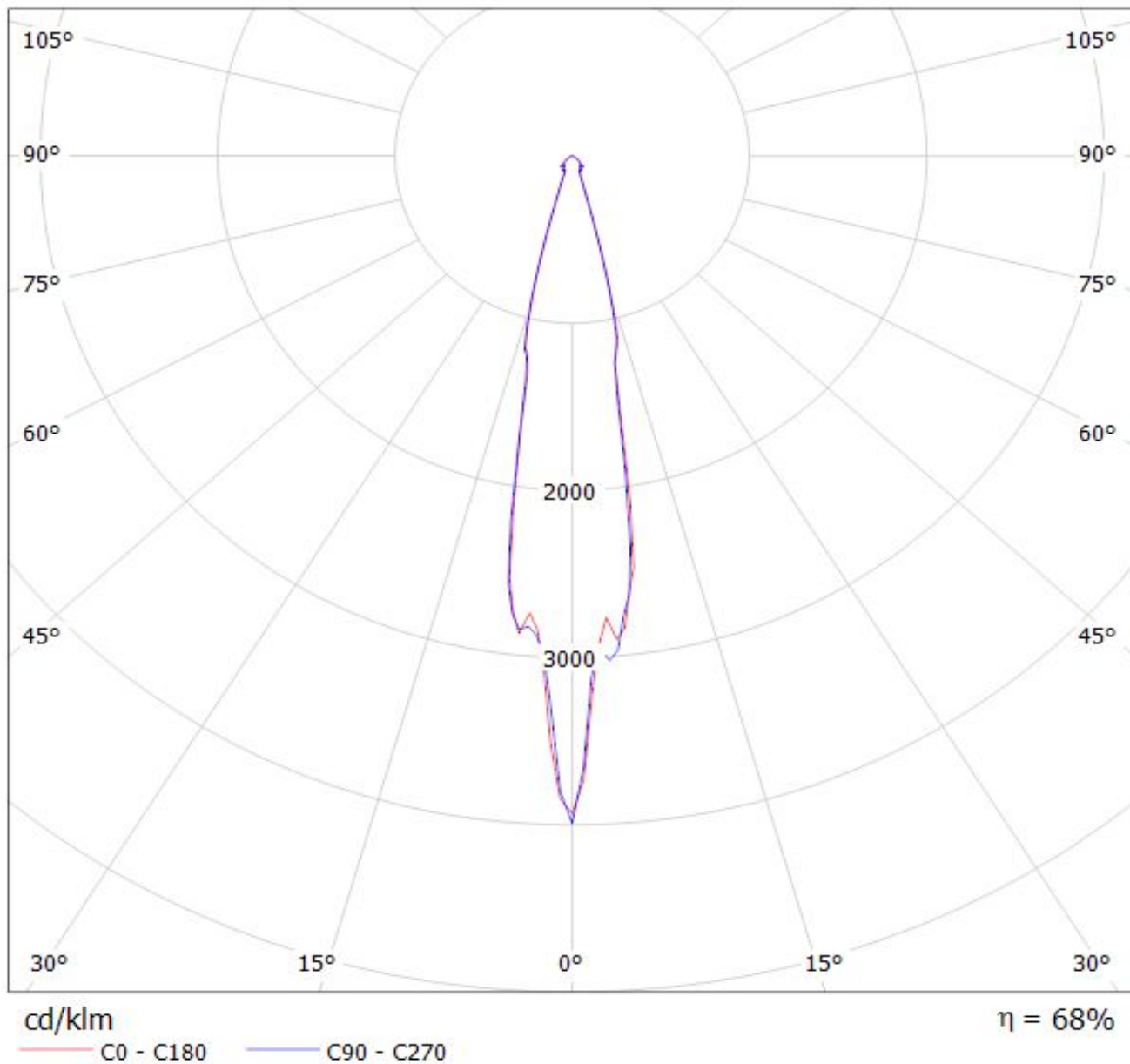

Luminaire: LEDiL Oy C13254\_HELENA-B\_(Luxeon\_K12) Eff. 73,7%  
Lamps: 1 x Luxeon K12 (797lm@250mA)

