

BA -CLIP-SM-G5

BackLED CP G5 - Wire clip | – Mounting profiles



Product family features

- Compatible with BackLED G5 family
- Suitable for BA-TW-CP-G5/BA-XL-CP-G5/ BA-L-CP-G5/BA-M-HO-CP-G5/BA-M-CP-G5/BA-M-CP-G5-HF/ BA-S-CP-G5
- Quick and easy binding wire without extra tooling

Product family benefits

- Quick and simple snap-in fixing the cables of the LED modules, no tools required
- Robust aluminum profile

Areas of application

- Suitable for BA-TW-CP-G5, BA-XL-CP-G5, BA-L-CP-G5, BA-M-HO-CP-G5 , BA-M-CP-G5, BA-M-CP-G5-HF, BA-S-CP-G5

Product datasheet

Technical data

Dimensions & weight

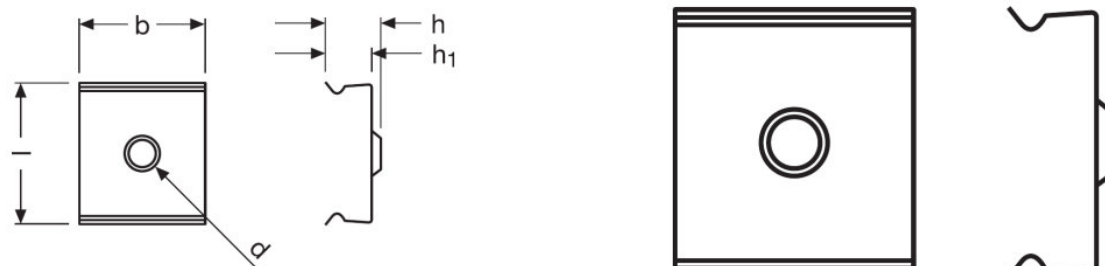

Product weight	1.26 g
Length	16.2 mm
Width	15.0 mm
Height	5.7 mm

Logistical data

Commodity code	761699909900
----------------	--------------

Environmental information

Information according Art. 33 of EU Regulation (EC) 1907/2006 (REACH)	
Date of Declaration	27-01-2022
Primary Article Identifier	4052899629349
Candidate List Substance 1	No declarable substances contained
Declaration No. in SCIP database	No declarable substances contained

Logistical Data

Product code	Product description	Packaging unit (Pieces/Unit)	Dimensions (length x width x height)	Volume	Gross weight
4052899629349	BA -CLIP-SM-G5	Shipping carton box 500	166 mm x 126 mm x 172 mm	3.60 dm ³	760.00 g

The mentioned product code describes the smallest quantity unit which can be ordered. One shipping unit can contain one or more single products. When placing an order, for the quantity please enter single or multiples of a shipping unit.

Product datasheet

Disclaimer

Subject to change without notice. Errors and omission excepted. Always make sure to use the most recent release.