

THIS IS A C.A.D. GENERATED DRAWING
DO NOT MAKE MANUAL REVISIONS TO MASTER.

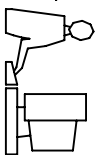

ISSUE NUMBER
① ORIGINAL
② NOTE ADDED FBRIONES JULY 15/99
③ PIN DIA'S ADDED FBRIONES OCT.29/99
④ DWG. UPDATING FBRIONES JUN.03/08

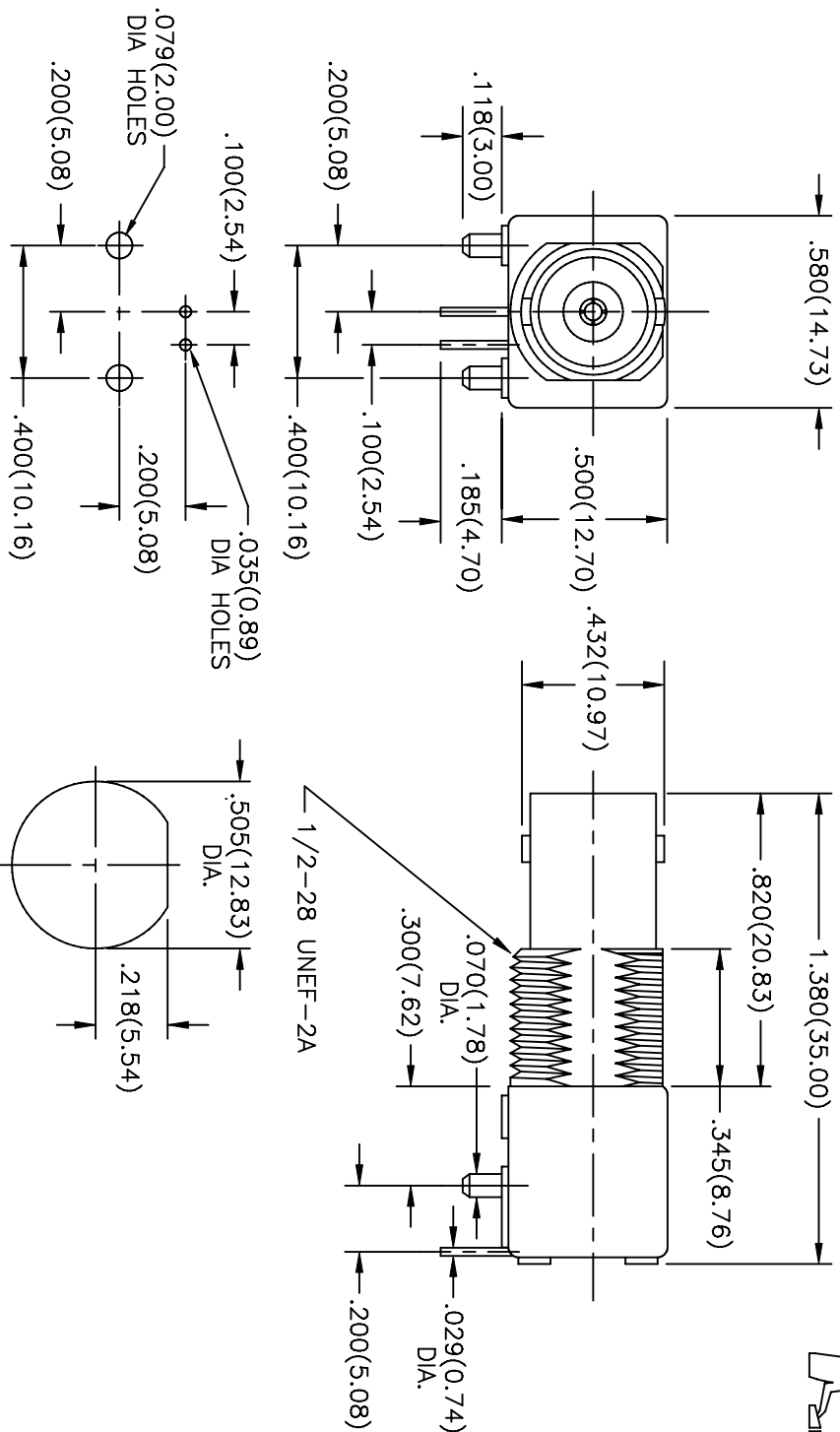

MATERIALS:
 BODY: ZINC DIECAST, NICKEL PLATED
 CONTACT: COPPER ALLOY, 30 MICROINCHES GOLD PLATED ON CONTACT AREA
 INSIDE WASHER: BRASS, TIN PLATED
 POST: BRASS, TIN PLATED
 INSULATOR: P.P.
 MOUNTING NUT (OPTIONAL): BRASS, NICKEL PLATED
 MOUNTING TOOTH WASHER (OPTIONAL): STEEL, NICKEL PLATED

NOTE:
 CONNECTOR MUST MEET EDAC SPEC 99-01



THIS SERIES FULLY CONFORMS TO THE
EUROPEAN UNION DIRECTIVES 2002/95/EC
AND 2002/96/EC FOR RoHS COMPLIANCY.

BNC, RIGHT ANGLE, 0.500" HIGH, P.C.B. 50 OHMS

EDAC INC
 TORONTO, ONTARIO
 CANADA
 YOUR CONNECTION TO QUALITY & SERVICE

THESE DRAWINGS AND SPECIFICATIONS
 ARE THE PROPERTY OF EDAC INC. AND
 SHALL NOT BE REPRODUCED OR COPIED
 OR USED AS THE BASIS FOR THE
 MANUFACTURE OR SALE OF APPARATUS
 WITHOUT WRITTEN PERMISSION.

DRAWN: F.BRIONES	DATE: FRB. 19/98
CHECKED:	DATE:
PART NUMBER	922-413-53A-303
DRAWING NUMBER	922-413-53A-303
ISSUE	4