

THIS IS A C.A.D. GENERATED DRAWING  
DO NOT MAKE MANUAL REVISIONS TO MASTER.

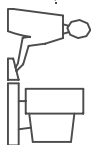

ISSUE NUMBER  
ORIGINAL

1

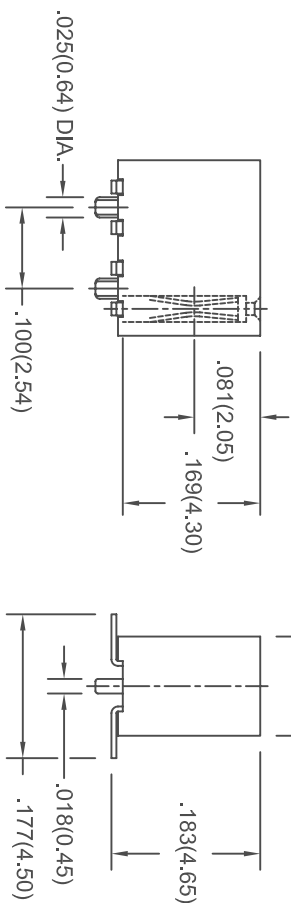
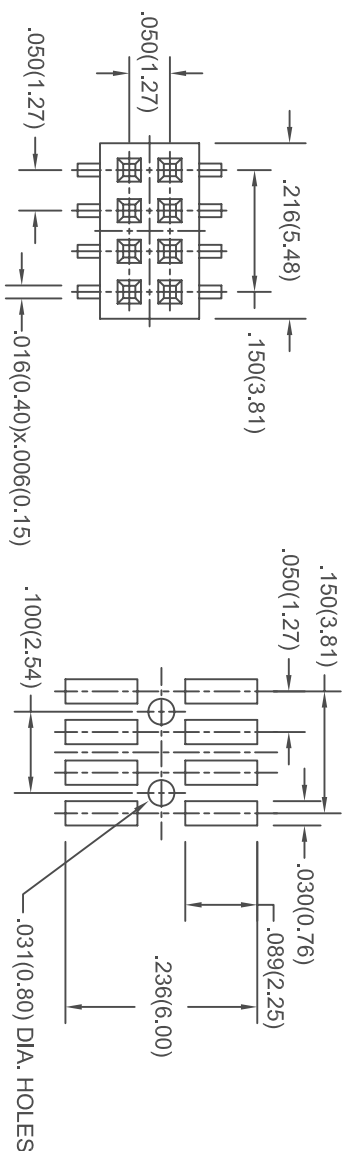

**MATERIALS:**

INSULATOR: LCP, UL94V-0, COLOR BLACK  
CONTACT: PHOSPHOR BRONZE GOLD PLATED  
OVER NICKEL

**ELECTRICAL:**

CURRENT RATING: 1 AMP  
CONTACT RESISTANCE: 20 MILLIOHMS MAX.  
INSULATION RESISTANCE: 5000 MEGOHMS MIN.  
DIELECTRIC WITHSTANDING: 500 VAC  
OPERATING TEMP.: -40°C TO +125°C  
MAX. PROCESSING TEMP.: 230°C FOR 60 SECONDS  
260°C FOR 10 SECONDS



THIS SERIES FULLY CONFORMS  
TO THE EUROPEAN UNION  
DIRECTIVES 2002/95/EC AND  
2002/96/EC FOR RoHS COMPLIANCY.

**SOCKET STRIP SURFACE MOUNT**

**EDAC INC**  
TORONTO, ONTARIO  
CANADA  
YOUR CONNECTION TO QUALITY & SERVICE

THESE DRAWINGS AND SPECIFICATIONS  
ARE THE PROPERTY OF EDAC INC. AND  
SHALL NOT BE REPRODUCED OR COPIED  
OR USED AS THE BASIS FOR THE  
MANUFACTURE OR SALE OF APPARATUS  
WITHOUT WRITTEN PERMISSION.

DRAWN: F. BRIONES	DATE: JUL. 12/10
CHECKED:	DATE:
PART NUMBER	
153-008-299-252	
DRAWING NUMBER	
153-008-299-252	
ISSUE	
1	