

TSW-SERIES

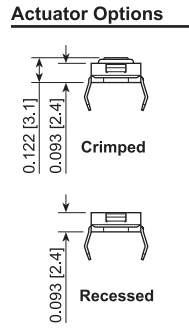
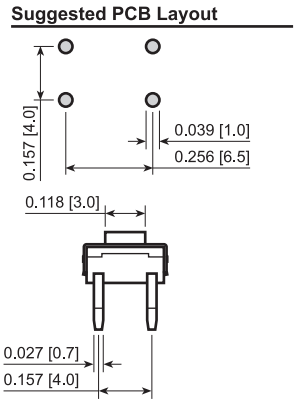
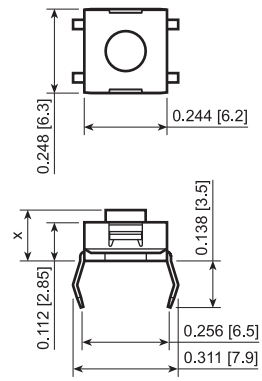

FEATURES:

- Washable
- Reliable and Economical
- Tube or Tape and Reel Packaging

SPECIFICATIONS:

RATING: 50mA 12VDC

TEMPERATURE: -20°C to 70°C (Operating)
-30°C to 80°C (Storage)

ELECTRICAL LIFE: For Silicone Actuators:
500,000 Cycles
For Crimped and Recessed:
100,000 Cycles

CONTACT RESISTANCE: 100mΩ Max. at 5VDC

INSULATION RESISTANCE: 100MΩ Min. at 500VDC

DIELECTRIC STRENGTH: 250VAC for 1 Minute

VIBRATION TEST: MIL-STD-202 METHOD 201A

SHOCK TEST: MIL-STD-202 METHOD 213B

OPERATION FORCE: Varies

TSAMW-SERIES

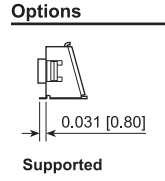
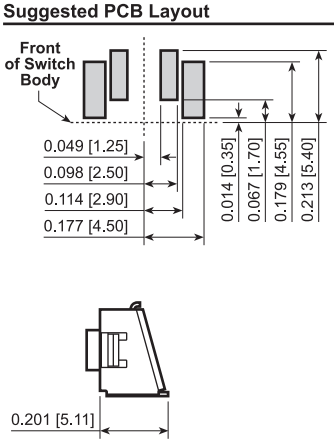
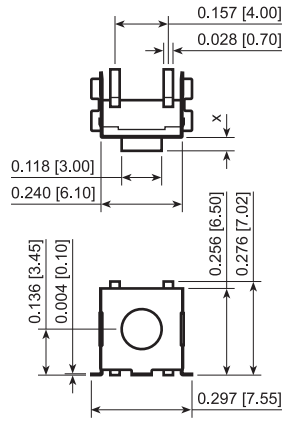

MATERIALS:

BASE: Polyamide 6/6, UL94 V-0

COVER: Stainless Steel
Tin Plated Steel

ACTUATOR: Silicone Rubber
Polyamide 6/6, UL94 V-0
Nickel Plated Brass

CONTACTS: Silver Plated Phosphor Bronze
Stainless Steel

TERMINALS: Silver Plated Brass



TSW-3.8-180-B

TSMW-SERIES and TSJW-SERIES

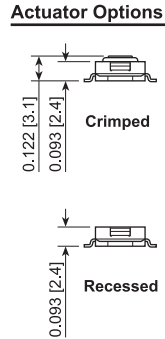
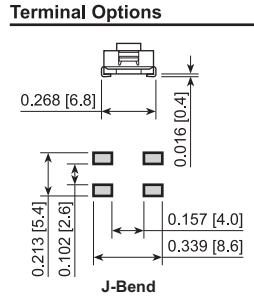
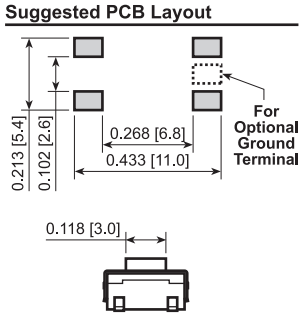
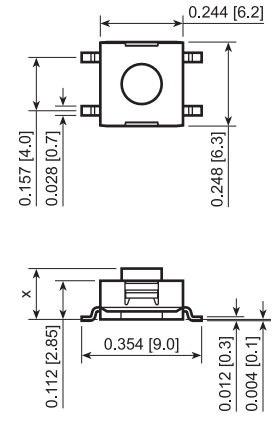

TSAMW-3.3-260-S-TR

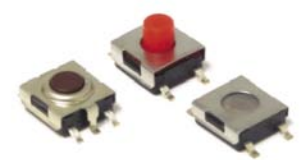

TSM9W-3.1CG-160-TR
TSM9W-5.2-260-TR
TSM9W-2.3R-160-TR

Series	Actuator Height (X Dimension)	Actuation Force	Options	Packaging
<input type="checkbox"/> TSW - Through Hole, Washable <input type="checkbox"/> TSAMW - Right Angle SMT, Washable <input type="checkbox"/> TSM9W - Gull Wing SMT, Washable <input type="checkbox"/> TSJW - J-Bend SMT, Washable	For TSW, TSMW, and TSJW Series: 2.3R - Recessed 3.1C - Crimped 3.1CG - Crimped, Grounded 3.5 3.8 4.5 5.2 For TSAMW Series: 0.0 0.8 1.0 2.35 3.3	For TSW, TSMW, and TSJW Series: 160 - 160gf (*) 180 - 180gf (**) 260 - 260gf 360 - 360gf For TSAMW Series: 180 - 180gf 260 - 260gf	For TSW, TSMW, and TSJW Series: None For TSAMW Series: U - Not Supported S - Supported	For TSW Series: B - Tube For TSM9W and TSJW Series: B - Tube TR - Tape and Reel For TSAMW Series: None - Bulk TR - Tape and Reel

Notes:
* = Available with 2.3R, 3.1C, and 3.1CG Actuators Only.
** = Available with 3.5, 3.8, 4.5, and 5.2 Actuators Only.

EXAMPLE PART NUMBERS:

TSM9W-3.1C-160-TR 3.1mm
9.0mm Gull Wing SMT, Crimped Actuator

TSJW-3.1C-160-TR 3.1mm
J-Bend SMT, Crimped Actuator

SPECIFICATIONS SUBJECT TO CHANGE WITHOUT NOTICE

TACTILE