

ABSOLUTE MAXIMUM RATINGS AT 25°C AMBIENT	550-1510-805 (GREEN)	550-1610-806 (AMBER)	550-1710-807 (RED)	UNITS
CONTINUOUS FORWARD CURRENT	30	50	50	mA
REVERSE VOLTAGE (I _r = 100 μA)	5	5	5	V
SOLDERING TEMPERATURE (.06 in. BELOW SEATING PLANE FOR 5 SEC)	260	260	260	°C
OPERATING TEMPERATURE	-20 TO +100	-40 TO +100	-40 TO +100	°C
STORAGE TEMPERATURE	-55 TO +100	-40 TO +120	-40 TO +120	°C

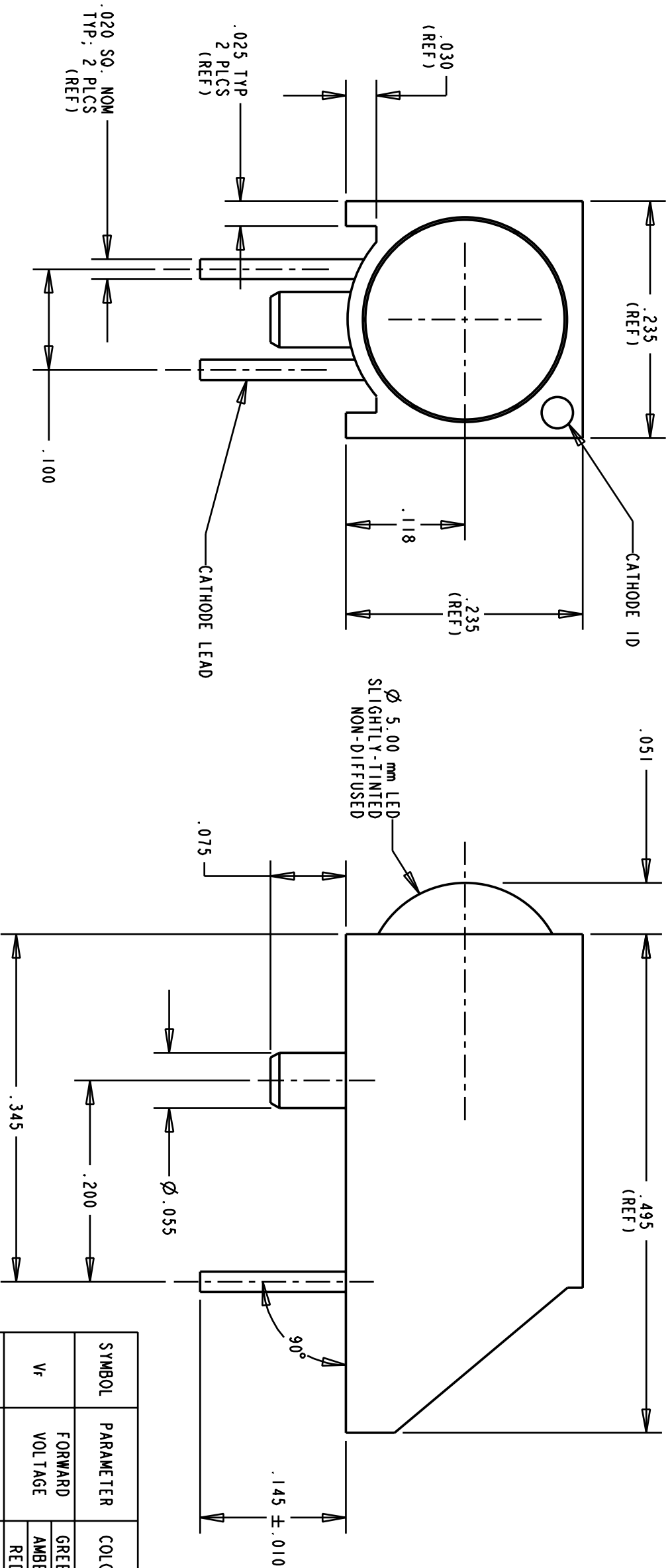

SYMBOL	PARAMETER	COLOR	MIN	TYP	MAX	UNITS	TEST CONDITIONS
V _f	FORWARD VOLTAGE	GREEN AMBER RED		2.2 2.02 1.9	3.0 2.4 2.4	V	I _f = 20 mA
λ _{pk}	PEAK WAVELENGTH	GREEN AMBER RED		568 592 635		nm	MEASURED AT PEAK
I _v	LUMINOUS INTENSITY	GREEN AMBER RED	170 1600 1400	300 3100 2100		mcd	② 20 mA

THIS DRAWING AND THE CONTENTS HEREIN ARE CONFIDENTIAL AND THE SOLE PROPERTY OF DIALIGHT. REPRODUCTION OF THIS DRAWING OR CONSTRUCTION OF ANY PARTS WITHIN THIS DRAWING ARE FORBIDDEN WITHOUT THE WRITTEN CONSENT OF DIALIGHT.

SCALE 8:1

ALL DIM'S IN: INCHES (MM)

TOLERANCES: UNLESS OTHERWISE SPECIFIED

FRACTIONS: ±1/64

DECIMALS (.XX): ±.02

DECIMALS (.XXX): ±.015

DECIMALS (.XXXX): ±.0005

ANGLES: ±3°

FINISH:

DRAWING NUMBER	C-16426	REV	A
TITLE	∅ 5.00 mm CBI		
MATERIAL			
FSCM	83330		

RECOMMENDED HOLES LAYOUT

DIALIGHT PART NUMBERS: 550-1510-805 (GREEN)
550-1610-806 (AMBER)
550-1710-807 (RED)

REV.	ECN NO.	REVISIONS	DRN.	CKD.	APP.	DATE
A		NEW RELEASE				

Dialight
1501 ROUTE 34 SOUTH
FARMINGDALE, NJ 07727