

Universal D-Series — Dual Mount

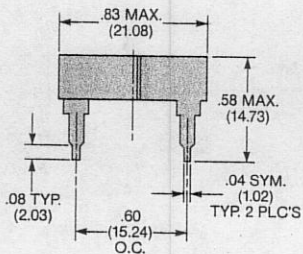

Dimensions are for reference use only. Contact IERC for dimensions with tolerances or standard part drawings.

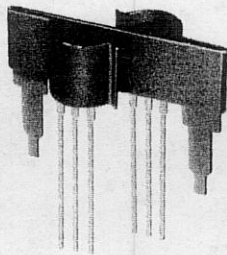
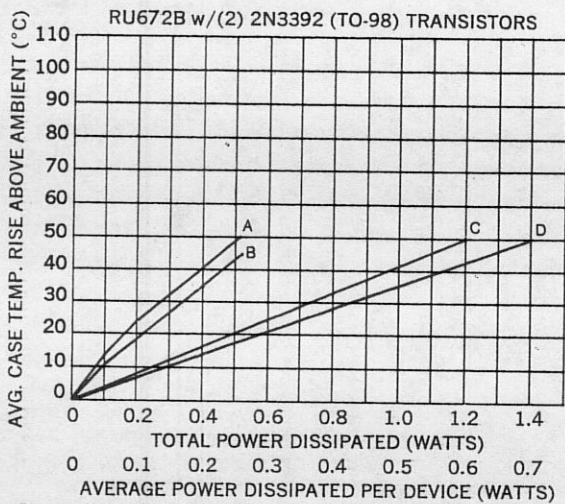

DESCRIPTION OF CURVES
 A. N.C. Horiz. Device Only Free Standing.
 B. N.C. Horiz. & Vert. With Dissipator.
 C. 500 FPM w/Diss.
 D. 1000 FPM w/Diss.

- Derate 8.0 °C/watt per device for unplated part in natural convection only.
- Case Temperatures Match Within 2°C at equivalent power levels.

Ordering Information

Unplated	IERC PART NO.		Semiconductor Accommodated	Material	Max. Weight (Grams)
	Black Coating	Black Cadmium			
RU67B2U	RU67B2CB	RU67B2B	Two D-case plastic trans.	Brass	0.6
RU672U	RU672CB	RU672B	Two D-case plastic trans.	Be Cu	0.6

Freestanding D-Series — Single Mount

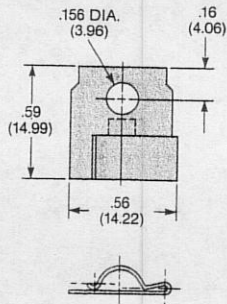
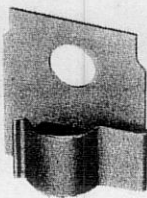

Dimensions are for reference use only. Contact IERC for dimensions with tolerances or standard part drawings.

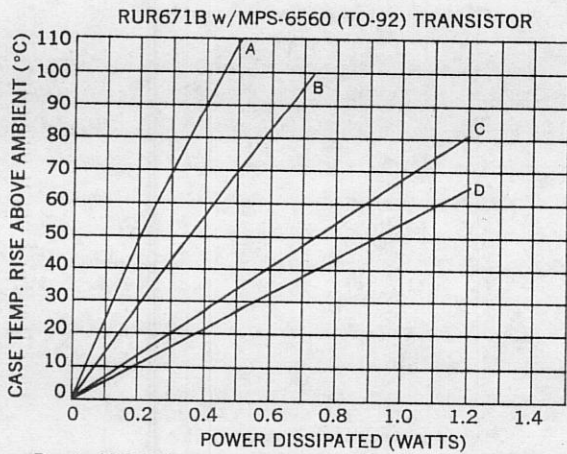

DESCRIPTION OF CURVES
 A. N.C. Horiz. Device Only Free Standing.
 B. N.C. Horiz. & Vert. With Dissipator.
 C. 500 FPM w/Diss.
 D. 1000 FPM w/Diss.

- Derate 10.0 °C/watt for unplated part in natural convection only.

Ordering Information

Unplated	IERC PART NO.		Semiconductor Accommodated	Material	Max. Weight (Grams)
	Black Coating	Black Cadmium			
RUR67B1-U	RUR67B1CB	RUR67B1B	One D-case plastic trans.	Brass	0.8
RUR67B1-2U*	RUR67B1-2CB*	RUR67B1-2B*	One D-case plastic trans.	Brass	0.8
RUR671U	RUR671CB	RUR671B	One D-case plastic trans.	Be Cu	0.8
RUR671-2U*	RUR671-2CB*	RUR671-2B*	One D-case plastic trans.	Be Cu	0.8

*Part features positive stop.