

## Series TB200 & TB200HB Double Row Terminal Blocks

### SPECIFICATIONS

**Rating:** TB200 - 30A, 300V\*

TB200HB - 30A, 600V\*

**Center Spacing:** .437" or 7/16" (11.10 mm)

**Wire Range:** #12 - 22 AWG CU

**Screw Size:** #6-32 phillslot screws

**Torque Rating:** 9 in.-lb.

**Distance Between Barriers:** .353" (8.97 mm)

**Mounting:** #6 screws

**Operating Temperature:** 130°C (266°F) max., -40°C (-40°F) min.

**Materials:** Molded base: Black, UL rated 94V0 thermoplastic

Terminal plating: Tin over brass; Screws: Zinc plated steel

**Breakdown Voltage:** 4800V

**Agency Information:** UL/CSA; IEC Compliance;  
CE Certified

\* Max. rating shown; some options may be rated lower - consult factory.

Poles	A	B	Poles	A	B	Poles	A	B
02	1.63	1.31	12	6.00	5.68	22	10.37	10.06
03	2.07	1.75	13	6.44	6.12	23	10.81	10.50
04	2.51	2.18	14	6.87	6.56	24	11.25	10.93
05	2.94	2.62	15	7.31	7.00	25	11.68	11.37
06	3.38	3.06	16	7.75	7.43	26	12.12	11.81
07	3.82	3.50	17	8.19	7.87	27	12.56	12.25
08	4.25	3.93	18	8.62	8.31	28	13.00	12.68
09	4.69	4.37	19	9.06	8.75	29	13.44	13.12
10	5.13	4.81	20	9.50	9.18	30	13.87	13.56
11	5.57	5.25	21	9.94	9.62			

\* Dimensions in inches. To convert to millimeters, multiply by 25.4.

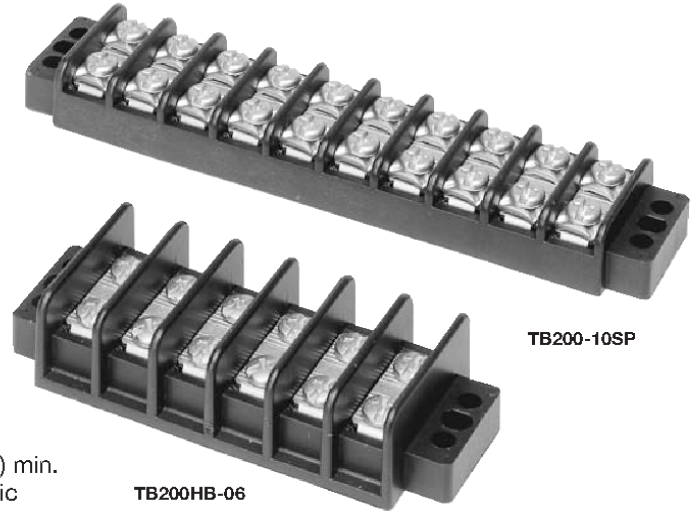

### TB200

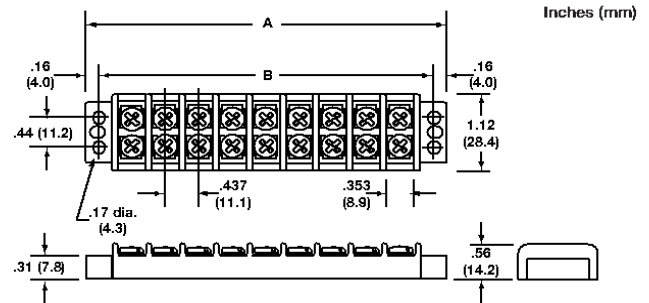

### TB200HB

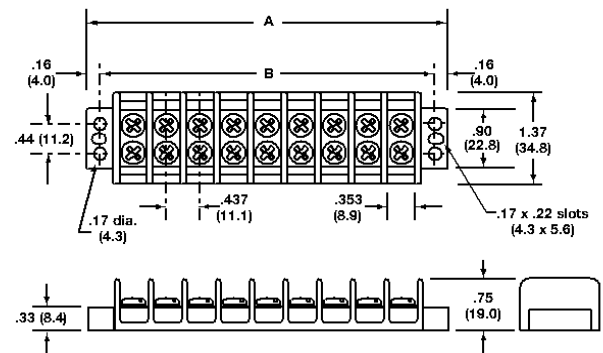

## Part Numbering System

### Series

T B 2 0 0

200 - Standard  
200HB - High barrier

### Poles

0 2

02 to 30

### Screw Options

0 0

Blank - steel phillslot, zinc plated  
00 - screws shipped bulk  
B - brass phillslot, nickel plated  
BS - brass Sems phillslot, nickel plated  
SP - steel Sems phillslot, zinc plated  
P - steel Sems (P-style)  
ST - stainless steel, phillslot  
SS - stainless steel Sems, phillslot  
STR - stainless steel, phillslot (recess)

### Marking

0 0

L1 to L6 - (pg 35)  
Marker strips (pg 33)  
Covers (pg 32)

### Hardware Options

0 0 0 0

QC1 to QC20 - quick connects  
J201 - flat slip-on jumper  
(2 position only)  
OJ3 - over barrier jumpers  
OJ5 - over barrier jumpers  
OJ7 - over barrier jumpers

## Screw Options



**B**  
Brass Philslot  
Nickel Plated



**BS**  
Brass SEMS  
Philslot Nickel Plated



**SP**  
Steel SEMS  
Philslot Zinc Plated



**P**  
Steel SEMS  
(P-Style)



**ST**  
Stainless Steel  
Philslot



**SS**  
Stainless Steel  
SEMS Philslot



**STR**  
Stainless Steel  
Phillips (recess)

## Hardware Options

**Quick Connects – Assembled** Terminals .250" x .031". Max. current rating 20 Amps. For other orientations, contact factory.



**QC1**



**QC2**



**QC3**



**QC4**

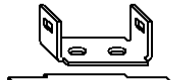

**QC5**

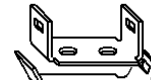

**QC6**

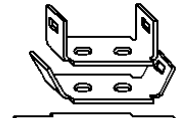

**QC7**



**QC8**



**QC9**



**QC10**



**QC11**



**QC12**



**QC13**

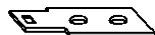

**QC14**



**QC15**



**QC16**



**QC17**

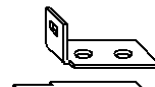

**QC18**

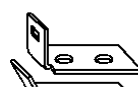

**QC19**

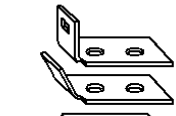

**QC20**

**Quick Connects – Bulk** Min. order per part no. – 100 pieces.



**QC201**  
Flat – none



**QC202**  
QC 45° – none



**QC203**  
QC 90° – none

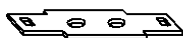

**QC204**  
Flat – Flat



**QC205**  
Flat – QC 45°

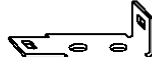

**QC206**  
Flat – QC 90°



**QC207**  
QC 45° – QC 45°



**QC208**  
QC 45° – QC 90°



**QC209**  
QC 90° – QC 90°

**Jumpers – Bulk** Min. order per part no. – 100 pieces. Contact factory for jumper assembly.



**J201**  
Flat slip-on  
(not available on  
TB200HB)

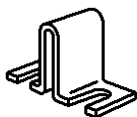

**OJ3**  
Slip-on over barrier  
for TB200HB

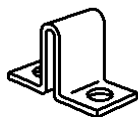

**OJ5**  
Closed over barrier  
for TB200HB

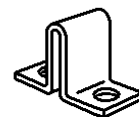

**OJ7**  
Closed over barrier  
for TB200