

Series A4000 & Series B4000 Single Row Terminal Blocks

SPECIFICATIONS

- Rating:** See table.
- Center Spacing:** .562" or 9/16" (14.28 mm)
- Wire Range:** See rating table.
- Screw Size:** #8-32 or #10-32 zinc plated slotted screws
- Torque Rating:** #8 screw size 16 in.-lb.; #10 screw size 20 in.-lb.
- Distance Between Barriers:** .47" (11.9 mm)
- Operating Temperature:** 105°C (221°F) max., -40°C (-40°F) min.
- Molded Material:** Black, UL Rated 94V0 Thermoplastic
- Hardware:** Bottom studs supplied with nuts assembled. Cup washers are optional on bottom studs but are not recommended with ring terminals.
- Extended Hex Nuts:** Optional extended, slotted hex nuts enable easier installation and removal with hex wrench or screwdriver. Available in bulk for the #10-32 studs on Series A4953 blocks. Specify part no. F582 and quantity.
- Breakdown Voltage:** 6100V
- Agency Information:** UL/CSA; CE Certified

RATING TABLE

Part Number	Terminal Top	Terminal Bottom	Wire* Range CU	Rated
A4003XX	# 8 Screw	#8 Stud	8-16 AWG	150V; 50 amps
A4011XX	# 8 Screw	Solder	10-16 AWG	600V; 35 amps
A4013XX	# 8 Screw	Solder	10-16 AWG	600V; 35 amps
A4021XX	# 8 Screw	.250 QC	10-16 AWG	600V; 35 amps
A4035XX	# 8 Screw	Closed	8-16 AWG	600V; 50 amps
A4041XX	#10 Screw	Solder	10-16 AWG	600V; 35 amps
A4043XX	#10 Screw	Solder	10-16 AWG	600V; 35 amps
A4051XX	#10 Screw	250 QC	10-16 AWG	600V; 35 amps
A4803XX	#10 Screw	#8 Stud	8-16 AWG	150V; 50 amps
A4813XX	#10 Screw	Solder Turret	10-16 AWG	600V; 35 amps
A4843XX	#10 Screw	#8 Screw	8-16 AWG	150V; 50 amps
A4953XX	#10 Stud	#10 Stud	8-16 AWG	150V; 50 amps
B4843XX	#10 Screw	#8 Screw	8-16 AWG	600V; 50 amps

* All models 30A Max. with 10 AWG;
35-50A ratings with 8 AWG using ring or fork type terminals.
Note: 50A rating achieved with #8 copper wire crimped to ring terminal.

Poles	A (in.) Mount Centers	B (in.) Length
2	1.69	2.12
3	2.25	2.68
4	2.81	3.24
5	3.37	3.80
6	3.93	4.36
7	4.50	4.93
8	5.06	5.34
9	5.62	6.05
10	6.18	6.61
11	6.74	7.17
12	7.31	7.74
13	7.87	8.30
14	8.43	8.86
15	8.99	9.44
16	9.55	9.98
17	10.12	10.55
18	10.68	11.11

* Dimensions in inches. To convert to millimeters, multiply by 25.4.

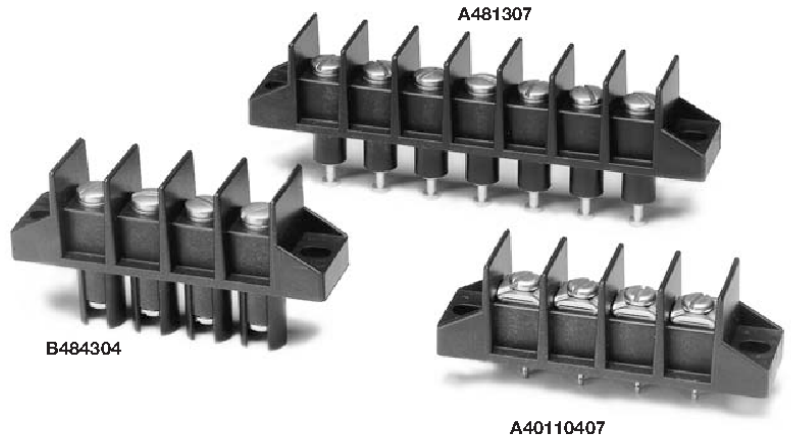

A4000 Series

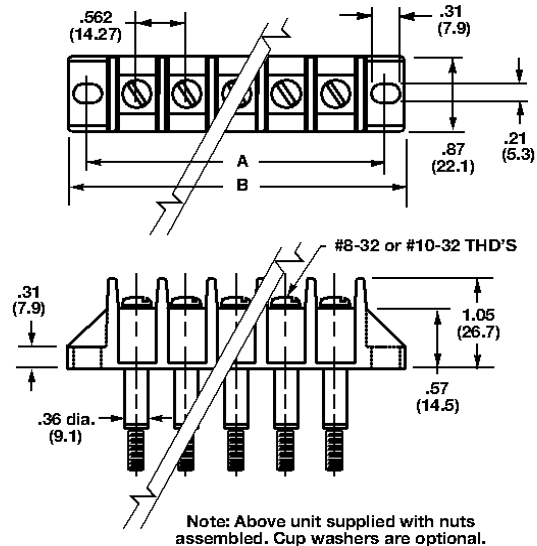

Optional Cup Washers Assembled

Available on A4003, A4803, A4843, A4953 & B4843.

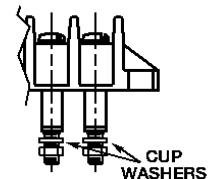

Reference Panel Cutout for 6 Position Block

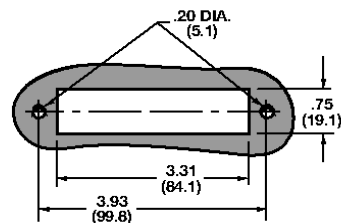

Part Numbering System

Series



A4 - standard
B4 - barrier

Terminal Style



00 - screw top; stud bottom
01 - screw top; solder bottom
02 - #8 screw top; .250 QC bottom
03 - screw top only
04 - #10 screw top; solder term. b.
05 - #10 screw top; .250 QC bottom
80 - screw top; stud bottom insulated base
81 - screw top; solder turret bottom
84 - screw top; screw bottom
95 - stud top; stud bottom

Base/End



1 - flat base/
mount end
3 - insulator base/
mount end
5 - closed base/
mount end

Poles



02 to 18

Screw Options



Blank - std. screw
00 - screws shipped bulk
04 - brass nickel plated
07 - steel SEMS zinc plated (not available with hardware options; not available on A4003, A4803, A4813, A4843, B4843)

Options



A1 to A9 - .250" QC
CW - cup washer (pg 20)
J301 - flat slip-on jumper (2 position only)
L1 to L6 marking options (pg 22)
S1 & S2 - solder lugs/flat
Covers - (pg 23)

Terminal Styles

Inches (Millimeters)

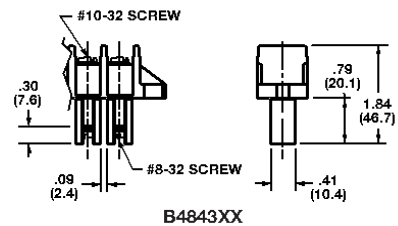
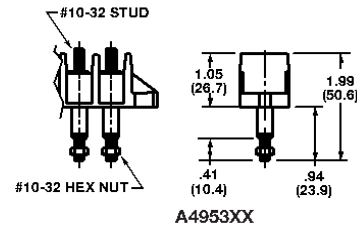
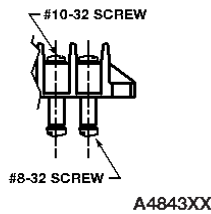
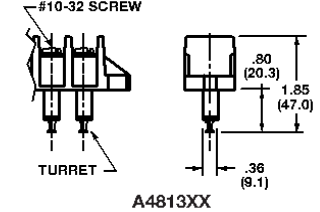
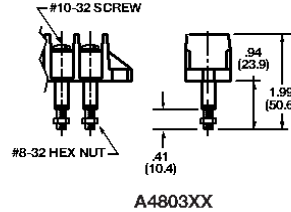
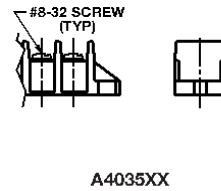
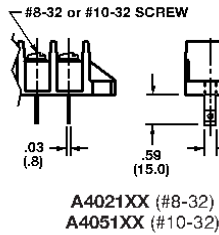
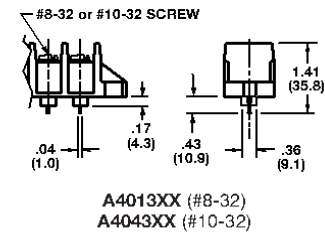
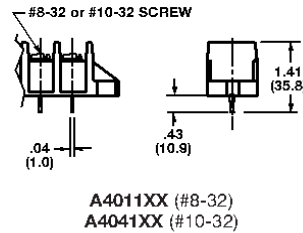
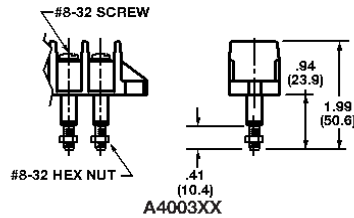

Hardware Options (Bulk ordering part numbers are in parentheses.)

Inches (Millimeters)

Solder Lugs

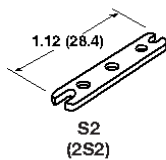
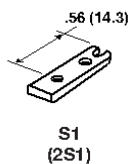

Jumpers

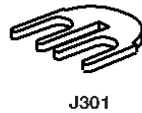

Quick Connects Blade Width A = .250". (For other orientations, contact factory.)

