

TOP VIEW

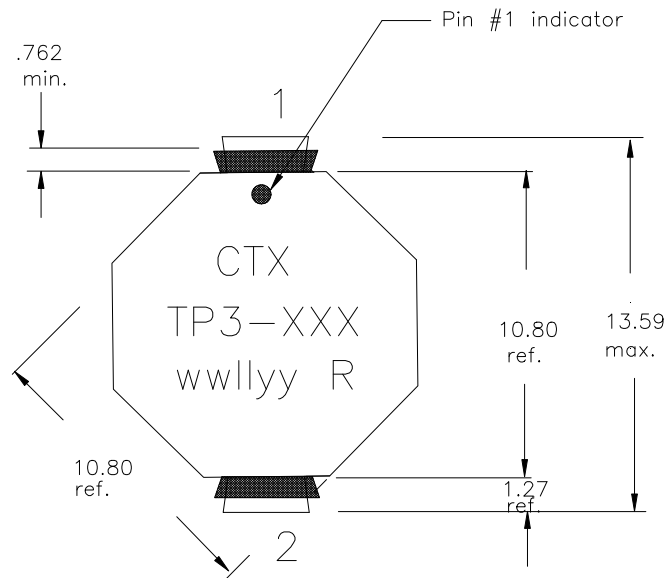

FRONT VIEW

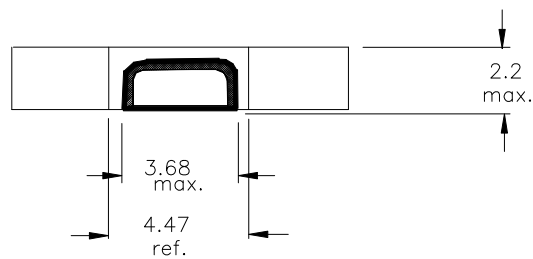

RECOMMENDED PCB PAD LAYOUT

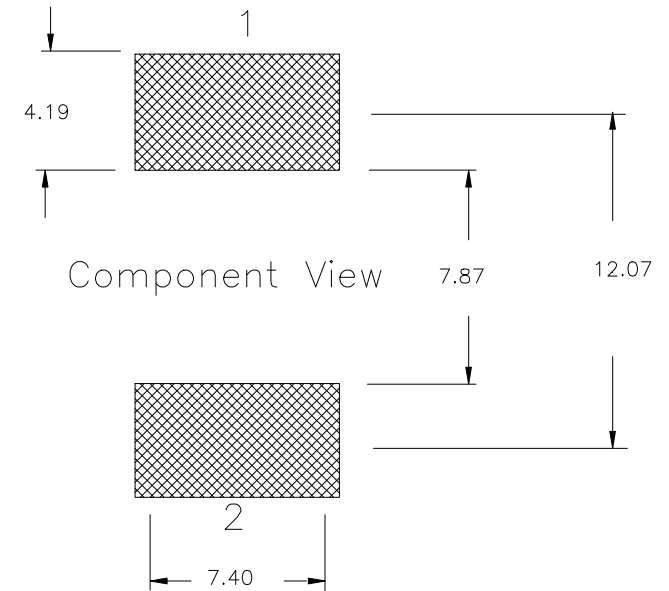

SCHEMATIC

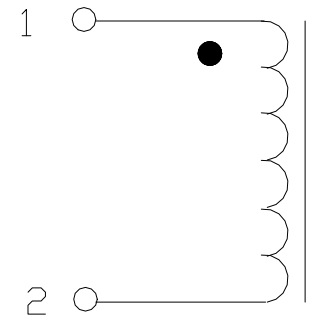

Notes:

- 1) Dimensions are in millimeters. Tolerances +/- .127mm unless otherwise specified.
- (2) Stamp as shown above, White Dot for pin 1 identifier
- (3) Line 1: CTX
- (4) Line 2: TP3- (Product code and Size)- (inductance value per family chart)
- (5) Line 3: wwllly (Date Code), R (Revision Level)
- (6) Magnet wire must be below top surface of case.

Cooper Electronic Technologies

3601 Quantum Boulevard Boynton Beach, FL 33426

SMT, 2 pad "bow tie", Octa-style,

Low profile inductor line

2.2mm max height. [ThinPac3 (TP3)]

FAMILY TABLE.

CUSTOMER INFORMATION

ThinPac3 (TP3) Family Table

Part Number	Rated Inductance (μH)	OCL nominal +/-20% (μH)		<u>I_{RMS} Amperes</u> for approximately a ΔT of 40°C. @ an ambient temperature of 85°C	<u>I_{SAT} Amperes Peak</u> for approximately 30% rolloff	DCR (Ω) max. @ 20°C.
TP3-R47	.47	.417		2.6	4.2	.0644
*TP3-1R0	1.0	1.15		2.1	3.4	.0949
TP3-1R5	1.5	1.65		2.0	2.8	.1064
*TP3-2R2	2.2	2.24		1.8	2.4	.1241
TP3-3R3	3.3	3.68		1.7	1.9	.1471
*TP3-4R7	4.7	5.45		1.5	1.6	.1806
TP3-6R8	6.8	7.47		1.4	1.3	.2051
*TP3-100	10.0	11.09		1.3	1.1	.2550
*TP3-150	15.0	15.17		1.2	.97	.2966
*TP3-220	22.0	23.99		1.1	.78	.3700
*TP3-330	33.0	35.08		.96	.64	.4433
*TP3-470	47.0	47.71		.90	.55	.5122

OCL (Open Circuit Inductance)
Test parameters: 100KHz,
.25Vrms, 0.0Adc.

Part numbers that are ***Bolded** are stocked standard products.
All others are not stocked but are available upon request.

Part number definition:
First 3 characters = Product code and size.
Last 3 characters = Inductance in μH. R=decimal point.
If no R is present third character = # of zeros.

(1) Units supplied in tape and reel packaging. 13" reels 1,500 parts per reel. Meets EIA-481 standard

Cooper Electronic Technologies
3601 Quantum Boulevard Boynton Beach, FL 33426
SMT, 2 pad "bow tie", Octa-style,
Low profile inductor line
2.2mm max height. [ThinPac3 (TP3)]
FAMILY TABLE.