



Tel (toll-free): +1-855-32-AAVID

[Register](#) [Log in](#)

Search

Home	Products	Solutions	Aavid Design	Tools & Docs	Contact	Company	Online Store
------	----------	-----------	--------------	--------------	---------	---------	--------------

» [Board Level Products](#)

531002B00000G

TO-202, TO-220, TO-220-single gauge (0.020")



Qty in stock: 1,540

Enter QTY:

[View Price](#)

Need assistance?

Call us: 1-855-32-AAVID

Email: [estore@aavid.com](mailto:estore@aavid.com)

» [Help Page](#)

Check Stock

Enter a part number for pricing and availability.

go!

[Request a Sample](#) ▶

[Request a Quote](#) ▶

[Ask an Engineer](#) ▶

- » [Product Return Policy](#)
- » [Terms & Conditions](#)
- » [Privacy Policy](#)

Extruded heat sink with radial fins and notched base

**Height:** 25.40

**Mount Orientation:** Vertical

**Finish:** Black Anodize

**RoHS:** compliant

**Thermal Resistance:** 13.40

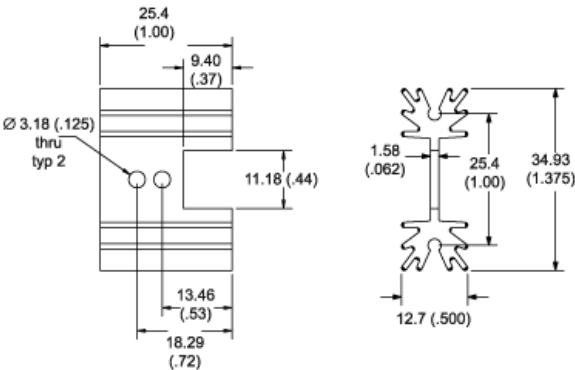

X Dim: 12.70 (0.500) | Y Dim: 0.79 (0.031) | Z Dim: 2.67 (0.105)

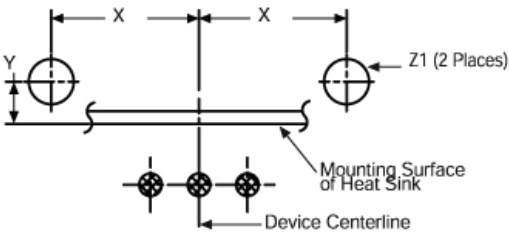

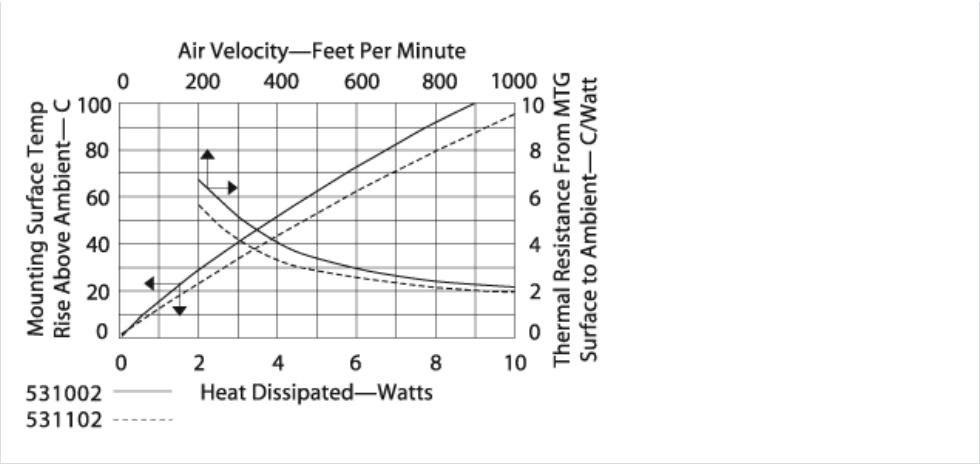

**Customer Assistance**

- [Contact Us](#)
- [Get Design assistance](#)
- [Find a Distributor](#)
- [Find a Sales Rep](#)
- [Request a Quote](#)
- [Placing an Order](#)
- [Terms and Conditions](#)
- [Returns](#)

**Popular Products**

- [Extrusions](#)
- [Board Level](#)
- [Liquid Cooling](#)
- [Heat Pipe Technology](#)
- [Heat Sink Accessories](#)
- [Interface Materials](#)

**Our Company**

- [About Aavid](#)
- [News and Events](#)
- [Management Team](#)
- [Worldwide Locations](#)
- [Directions to Headquarters](#)
- [Disclaimer](#)
- [Customer Survey](#)
- [Privacy Policy](#)

Sign up to receive Aavid news & alerts

go



Aavid will lead the electronics thermal management industry worldwide. We will be the first company customers call to enable their thermal designs anywhere in the world. We will respond with extraordinary speed and will provide them with timely and cost-effective solutions because we understand their needs, their industry, and their culture. 2012 Aavid Thermalloy, LLC