

Specifications: **MSM(MSE) Series****Features:**

- \*MSM is **green** color with clamp in the *open* position
- \*MSE is **black** with clamp in the *closed* position
- \*Captive screws
- \*Elevator clamp system
- \*Testing holes/points
- \*2 to 12 positions single mold
- \*2 to 36 positions modular
- \*Housing is resistant to chlorinated solvents, with no dioxin or detrimental to health halogens
- \*Every position of this product is mechanically and electrically tested during assembly to ensure a 100% defect free product
- \*Minimum 5 microns of tin plating on terminal for easy soldering

**Electrical**

Current:	17.5A @ 300V
Wire range:	14 to 30 AWG
Wire section(mm <sup>2</sup> ):	0.05 to 2.5mm <sup>2</sup>
Pin dimension:	1mm x 0.8mm
CR:	<15mΩ
IR:	>10 <sup>9</sup> Ω (500V DC)
Operating temp:	-40°C to +110°C
Stripping length:	6mm
Torque:	0.5 Nm
PCB holes:	min 1.4mm
PCB thickness:	max 2.8mm
Climactic category:	40/110/21 Acc. to IEC 68-1

**Materials**

Housing:	Polyamide 6,6 (UL94V-0)
Clamp:	Copper alloy, Ni plated
Terminal:	Copper alloy, Tin plated
Screw:	M3, copper alloy, Ni plated
Colors available:	Green, black

**Marking**

(See marking information on page 8)

Specifications: **320 Series****Features**

- \*Economical solution for angled wire entry
- \*2 and 3 positions modular
- \*Rising clamp for secure connection

**Electrical**

Current:	10A @ 250V
Wire range:	14 to 22 AWG
Pin dimension:	1mm x 0.7mm
CR:	<15mΩ
IR:	>10 <sup>9</sup> Ω (500V DC)
Operating temp:	-40°C to +110°C
Stripping length:	7mm
Torque:	4.5 lb-in
PCB holes:	min 1.4mm
PCB thickness:	max 2.4mm

**Materials**

Housing:	PBT-4115 (UL94V-0)
Wire protector:	Plated Steel
Terminal:	Brass, Tin plated
Screw:	M2.6, steel, zinc plated
Colors available:	Black (standard), blue

**Marking**

Marking not available

17.5A 300V

5 and 5.08mm

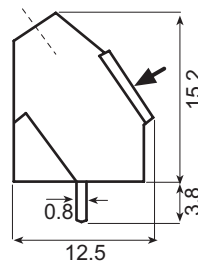
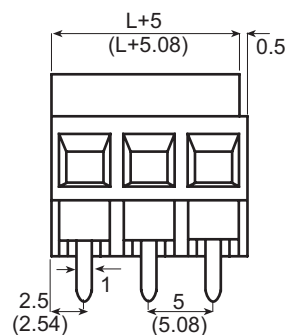
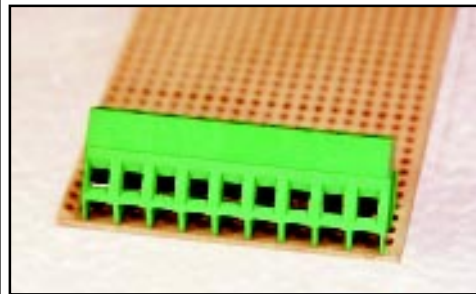
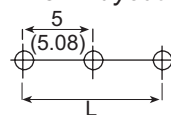
**PCB Layout****Dimensions**

n=number of poles

L=(n-1) x 5 (for 5mm spacing)

L=(n-1) x 5.08 (for 5.08mm spacing)

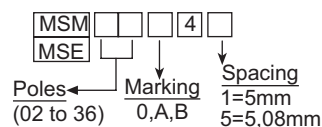
**Ordering Information**

Also available in 10mm and 10.16mm centers.

10A 250V

5mm

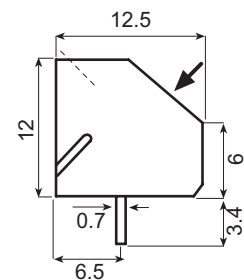
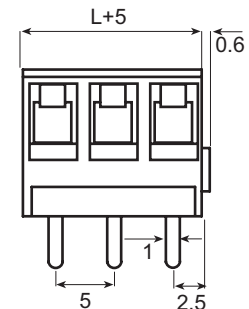
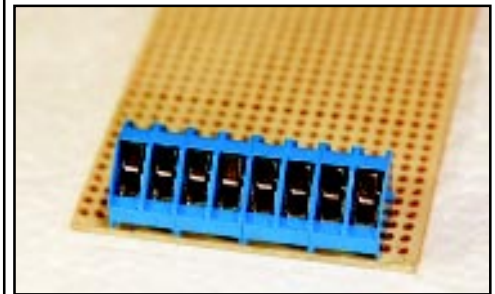
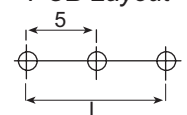
**PCB Layout****Dimensions**

n=number of poles

L=(n-1) x 5

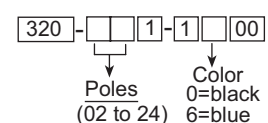
**Ordering Information**

Also available in 10mm centers.