

Part Number - 782003U02750G

	Part Number	Thermal Resistance °C/W at 3in length	Width in	Height in	Surface Area in <sup>2</sup> /in	Weight lb/ft
	78200	9.86	0.98	1.42	7.1	0.60

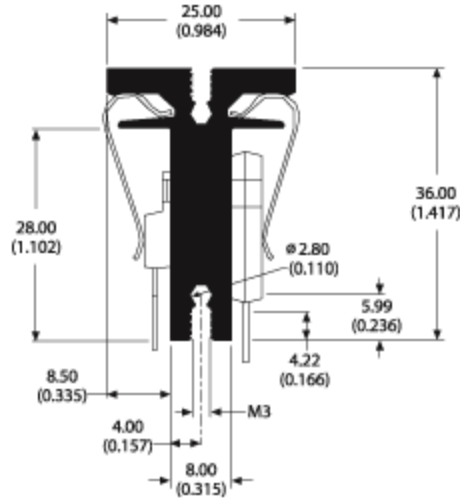

Thermal Curves

based on 3.000 in length

### Natural Convection

Heat Sink Temperature Rise Above Ambient

Heat Sink Thermal Resistance

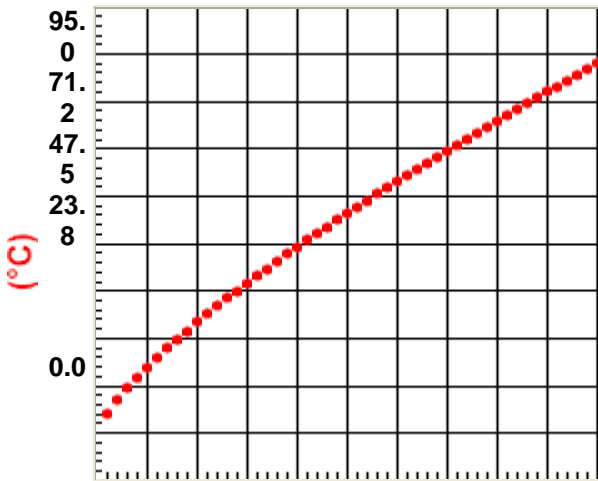

Power Dissipated (W)

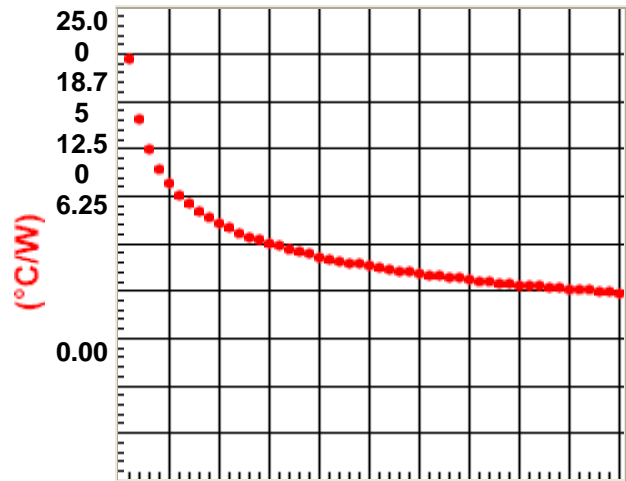

Power Dissipated (W)

## Forced Convection

Heat Sink Temperature Rise  
Above Ambient (10W Dissipated)

Air Flow (m/s)

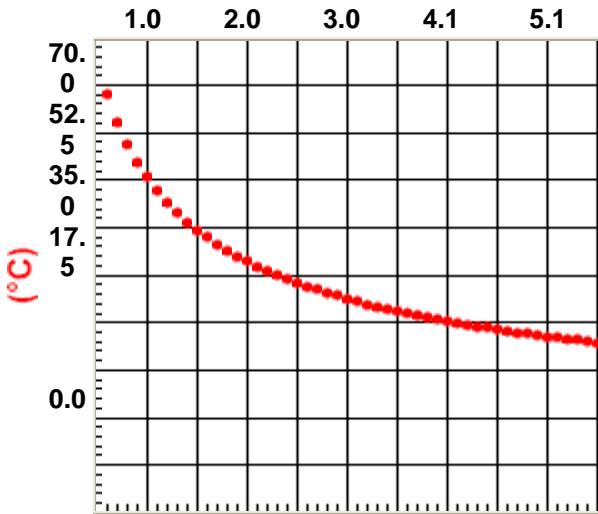

Air Flow (LFM)

Heat Sink  
Thermal Resistance

Air Flow (m/s)

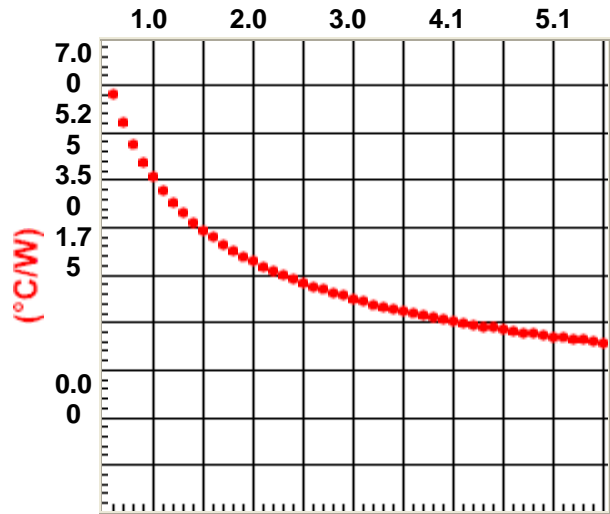

Air Flow (LFM)

## Building a Part Number (Full Bar Length = 8.20ft)

Base Part #	Bar Length	Finish	Length (use zeros for full or half bars)
78200	<u>1</u> Full	<u>E</u> Unfinished	0 0 0 0 0
	<u>2</u> Half	<u>E</u> Unfinished	0 0 0 0 0
	<u>3</u> Custom	<u>B</u> Black Anodized <u>C</u> Gold Chromate <u>U</u> Unfinished* <u>V</u> AavSHIELD <sup>3</sup>	<i>indicate length in inches to three decimal places;</i> 1 5 2 5 0 = 15.250 "

78200      \_      \_      \_      \_      \_

\*For unfinished extrusions with cut lengths other than half bar, the finish designation is a U. Standard Aavid Thermalloy parts require all 12 positions to be complete.